

RXC20 SERIES

High Voltage Contactors

200A CONTINUOUS DUTY

1000V SYSTEM VOLTAGE



FEATURES

SPST Normally Open High Voltage Contactors

- Hermetic ceramic seal with gas fill
- Meets RoHS 2011/65/EU
- High temperature performance
- CE certified



PERFORMANCE

TABLE 1. SPECIFICATIONS

CHARACTERISTIC	MEASURE
Contact Arrangement	Form X, SPST NO
Max Switching Voltage	1000 VDC
Dielectric Withstand Voltage Contacts to Coil	3000 VAC, 1 minute
Dielectric Withstand Voltage Across Open Contacts	4000 VDC, 1 minute
Continuous Current (53mm ² conductor)	200A
Overload Current	900A
30 seconds	400A
3 Minutes	
Make and Break	See table
Max Short Circuit Current -1 second	1500 A
Min Insulation Resistance	1000 MOhm @ 1,000V
Contact Resistance (typical)	0.15 mOhm
Operate Time (Max, incl bounce)	25ms
Release Time (Max)	10ms
Shock - Functional, 1/2 Sine, 11ms	20G
Shock – Destructive, 1/2 Sine, 11ms	50G
Operating Temperature	-40°C to 100°C (180°C max terminal temperature)
Ingress Protection	Exceeds IP69, (Hermetically sealed)
Mechanical life	300,000
COIL @ 20°C	MEASURE
Nominal Voltage	12V 24V 48V
Pick-up Voltage (Max)	8.5 VDC 17.0 VDC 38.4 VDC
Drop-out Voltage (Min)	0.6 VDC 0.9 VDC 3.3 VDC
Holding Current	0.46A 0.25A 0.12A
Coil Resistance +/- 5%	26Ω 100Ω 392Ω
Coil Power	5.5W 5.8W 6W

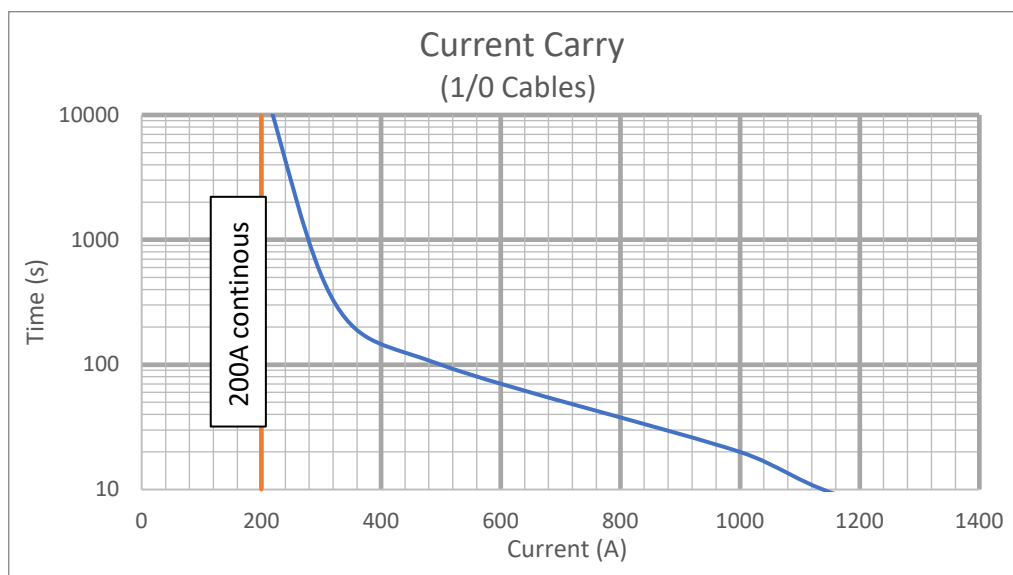

- 85C ambient
- 150C max terminal Temp
- 1/0 Cables

- Single pulse
- Graph provided for design reference; user to verify system temperatures

**TABLE 2. RESISTIVE LOAD SWITCHING
(MAKE / BREAK DATA)**

POLARITY SENSITIVE VERSION		CYCLES (1 cycle = 1 make + 1 break)
VOLTAGE	CURRENT	
750V	20A	20,000
750V	100A	1,000
750V	300A	2
900V	100A	100
450V	100A	7,500

OPTIONS

TABLE 3. PRODUCT NOMENCLATURE

		MOUNTING	COIL	AUXILIARY CONTACTS
RXC20	P Polarity Sensitive	1 Bottom Mount	A 12V single coil	X None
			B 24V single coil	
			C 48V single coil	

PRODUCT DIMENSIONS [mm]

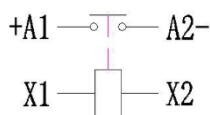
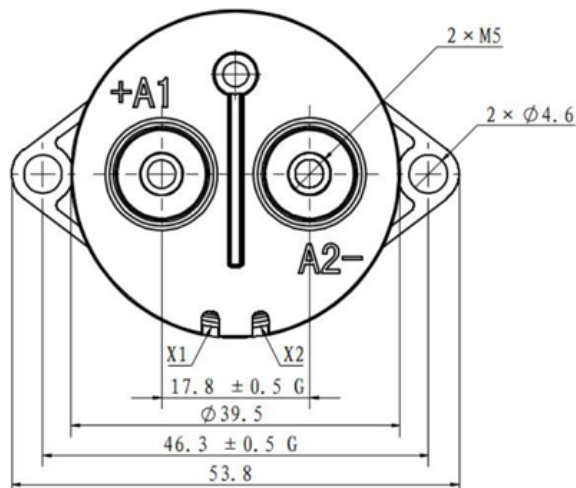
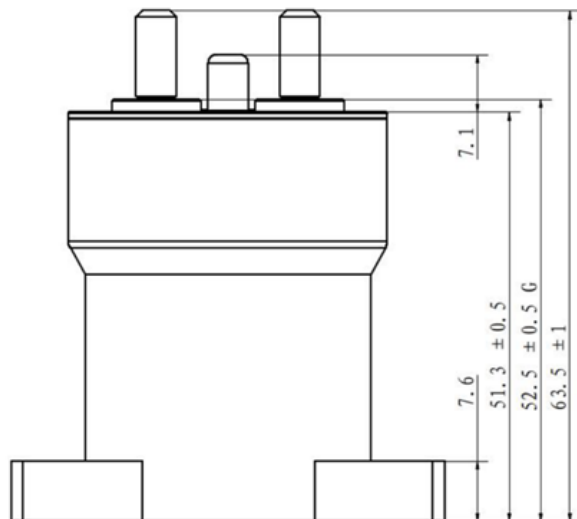
TABLE 4. DIMENSIONAL AND INSTALLATION

CHARACTERISTIC	MEASURE
Weight	185g (0.41 lb)
Mounting Position	Any / Not Position Sensitive
Package Quantity	30
Install Torque M5 Main Terminals	3-4Nm (26-36 in-lb)
Mounting Torque, M4 hardware	2.3Nm
Power Terminal Pad Material	Copper
Housing Material	Zytel FR50

NOTES

- Polarity Sensitive versions are marked +A1 and -A2 for the power terminals. For applications that require the contactor under load, please ensure current is flowing from the +A1 to the -A2 terminal when breaking/opening under load. For Bi-Directional versions the direction of current does not matter when breaking under load.
- Attached cables and busbars directly to the main terminal pad using the recommended install torque. Do not use washers or other materials between the contactor and the conductor. This will ensure the lowest possible contact resistance.
- Avoid excessive coil voltages. Exceeding the ratings on the datasheet may result in high coil temperature and coil failure.
- Contactor may be used above Max Switching Voltage if the application does not require significant load breaking. Please contact Rincon Power to discuss in more detail.

Legal Disclaimer Notice for Rincon Power, LLC Datasheet

This legal disclaimer applies to purchasers and users of products manufactured by or on behalf of Rincon Power, LLC ("Rincon"). Unless otherwise expressly indicated in writing, Rincon's products, product specifications and data sheets relating thereto are subject to change without notice. Users should check for and obtain the latest revision information and verify that such information is current and complete before placing orders for Rincon's products. Users should always verify the actual performance of the Rincon's products in their specific systems and applications.

Except as expressly set forth in the relevant purchaser order terms and conditions or applicable agreement, Rincon makes no warranty, representation or guarantee regarding the products, expressed or implied, including, but not limited to, a warranty of merchantability or fitness for a particular purpose. To the maximum extent permitted by applicable law, Rincon disclaims (i) any and all liability arising out of the application or use of any product, (ii) any and all liability, including without limitation special, consequential or incidental damages, and (iii) any and all implied warranties, including warranties of fitness for particular purpose, non-infringement and merchantability.

In no event shall Rincon be liable for any incidental or consequential damages resulting from the use, misuse or inability to use the product. This exclusion applies regardless of whether such damages are sought based on breach of warranty, breach of contract, negligence, strict liability in tort, or any other legal theory.