

**Mallory Sonalert Products, Inc.**

Part #:

**SBS12CHFL****Sales Outline Drawing**

Revision:

**C****Specifications:****cUL Recognized to IEC60601-1-8 AMD1  
Cardiac Melody - High Priority Only**

Sound Level Category:	Extra Loud
Mode of Operation:	High Priority Alarm - 10 beeps repeating every 2.5 sec
Voltage Rating:	9 to 12 VDC
Frequency:	150 to 4000 Hz
Loudness @ 10cm:	95 to 105 dB(A) Typ.
Average Current Draw:	<300mA Typ.
Ipk Current*:	400mA
Housing Material:	ABS 777D Plastic Resin, Black
Storage Temperature:	-40° to +85° C
Operating Temperature:	-30° to +65° C
Weight Typical:	1.1 oz (32g)
Options:	Please contact factory.

**Dimensions:** Inches (mm)**cUL Recognized****ROHS Compliant**

PATENT NUMBER: 7880593

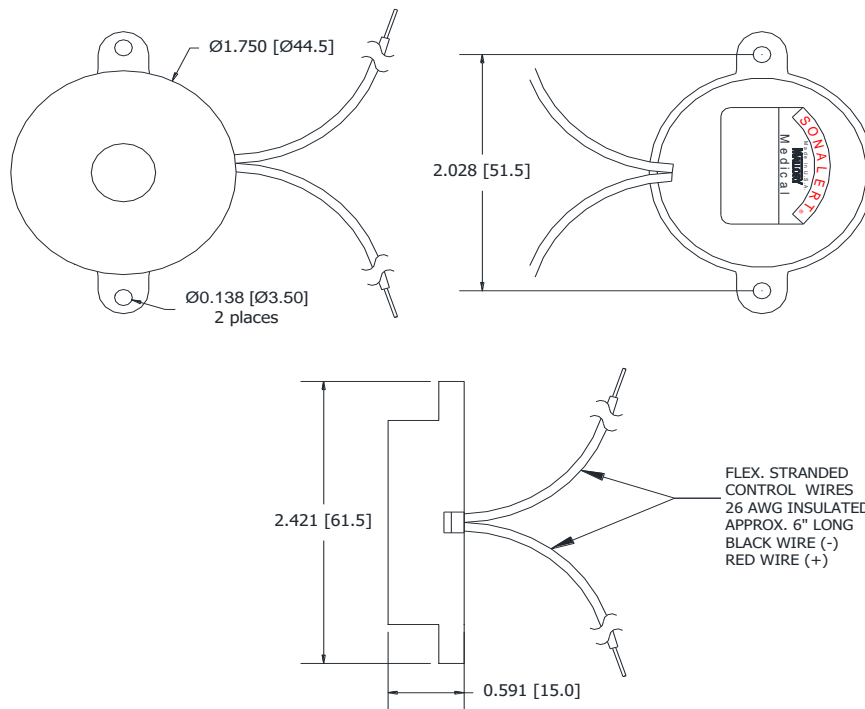

\*Ipk = Instantaneous Peak

tolerances:  $\pm 0.01$  [ $\pm 0.3$ ]  
 $\pm 0.005$  [ $\pm 0.1$ ]