

REVISIONS					
REV	ECO	DESCRIPTION	DATE	BY	APPR
A1	-	RELEASE NUMBER	04/JUL/23	MILO	TOMMY
A2	-	UPDATE DRAWING	22/JAN/24	LYNCH	TOMMY

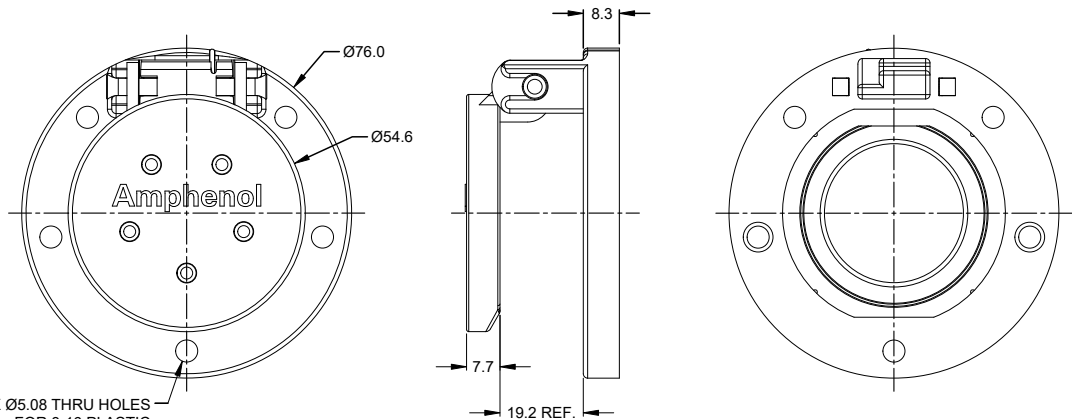

5 X Ø5.08 THRU HOLES  
FOR 8-16 PLASTIC  
SELF TAPPING SCREWS

RECOMMENDED TORQUE  
VALUES: 38-44 IN-LBS(4.29-4.97 N·M)

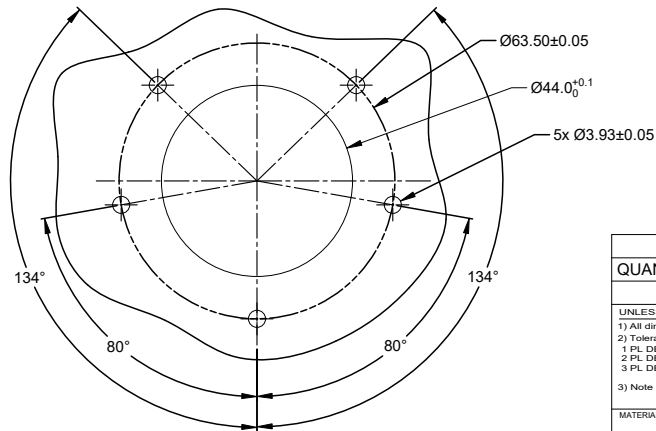
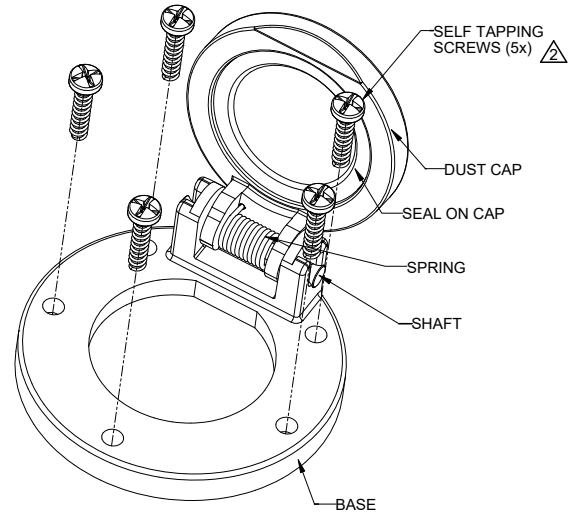

RECOMMENDED MOUNTING  
PANEL CUTOUT  
(PANEL TOP VIEW)

NOTE: UNLESS OTHERWISE SPECIFIED

1. MATERIAL:  
HOUSING/CAP: THERMOPLASTIC, BLACK  
SEAL: SILICONE RUBBER, RED  
SHAFT: ALUMINUM  
SPRING: STAINLESS STEEL  
SCREW: STAINLESS STEEL

5x SELF TAPPING SCREWS FOR PLASTIC(#8-16 x .750[19mm]) ARE INCLUDED

3. IP RATING: IP54 ( MATED CONDITION )

4. THE MOUNTING RING DOES NOT CREATE A SEAL WITH THE PANEL

AHDPSCC-24		REFERENCE: 5004-001-2405	
QUANTITY	PART NUMBER	DESCRIPTION	ITEM
MATERIALS LIST			
UNLESS OTHERWISE SPECIFIED 1) All dimensions are in metric(mm). 2) Tolerances are as follows: 1 PL DEC ±0.30 Fractions ±1/64 2 PL DEC ±0.15 Angles ±1° 3 PL DEC ±0.08 3) Note reference =		SIGNATURES DRAWN: LYNCH,PAN CHECKED: SULLEN,ZHANG ENGINEER: APPROVAL: TOMMY,XIE CUSTOMER:	DATE 22/JAN/24 23/JAN/24 24/JAN/24
MATERIAL SPECIFICATIONS: WEIGHT: 59.3g		<b>Amphenol</b> Sine Systems - www.sineco.com 44724 Morley Drive Clinton Township, MI 48036	
PROCESS SPECIFICATIONS:		THIS DRAWING IS SUPPLIED FOR INFORMATION ONLY. DESIGN FEATURES, SPECIFICATIONS AND PERFORMANCE DATA SHOWN HEREON ARE THE PROPERTY OF THE AMPHENOL CORPORATION. NO RIGHTS OF REPRODUCTION ARE IMPLIED. ALL DIMENSIONS ARE SUBJECT TO NORMAL MANUFACTURING VARIATIONS.	
NEXT ASSY:		SIZE B C-	REVISION A2
		SCALE NONE	SHEET 1 OF 1