

SK5100

THIS DRAWING CONTAINS INFORMATION PROPRIETARY TO POSITRONIC AND IT'S SUBSIDIARIES. POSITRONIC BELIEVES THE DATA ON THIS DRAWING TO BE RELIABLE, SINCE THE TECHNICAL INFORMATION IS GIVEN FREE OF CHARGE, THE USER EMPLOYS SUCH INFORMATION AT HIS OWN DISCRETION AND RISK. POSITRONIC ASSUMES NO RESPONSIBILITY FOR RESULTS OBTAINED OR DAMAGES INCURRED FROM USE OF SUCH INFORMATION IN WHOLE OR IN PART.

DATE	REV	REVISION RECORD	APP	DR	CK
8-12-03	NC	ECO 21272	RCW	ME	TK
9-14-16	A	ECO 52581	COLE	AC	COLE
12-14-17	B	ECO 58072	RK	GJ	AB

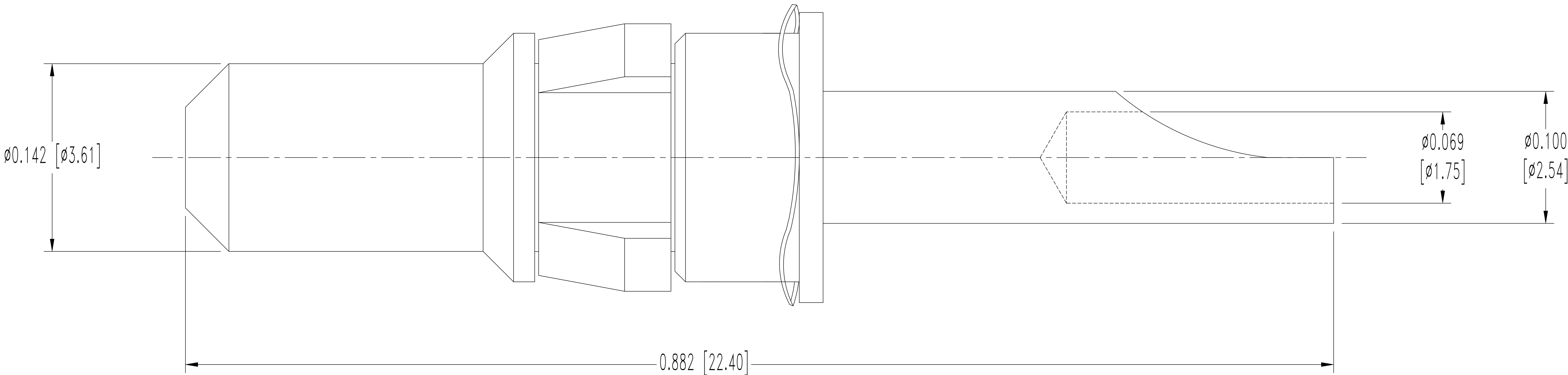

NOTES:

- MATERIALS AND FINISHES:  
CONTACTS: PRECISION MACHINED COPPER ALLOY, GOLD FLASH OVER NICKEL PLATE.  
SPRING WAVE WASHER: BERYLLIUM COPPER, GOLD FLASH OVER NICKEL PLATE.  
RETENTION RING: POLYETHERIMIDE, COLOR: BLACK.
- DETAILED PRODUCT, MECHANICAL AND ELECTRICAL INFORMATION IS AVAILABLE IN THE LATEST STANDARD DENSITY COMBO-D PRODUCT PUBLICATION AT [CONNECTPOSITRONIC.COM](http://CONNECTPOSITRONIC.COM).
- DIMENSIONS ARE IN INCHES [MILLIMETERS].

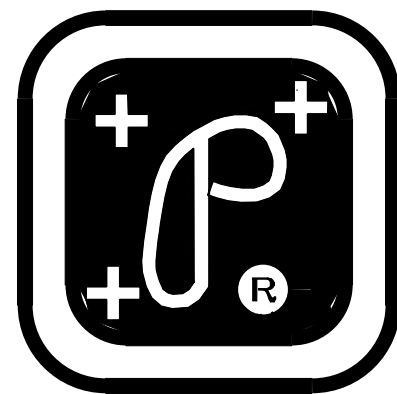

POSITRONIC INDUSTRIES INC.

SPRINGFIELD, MISSOURI 65801

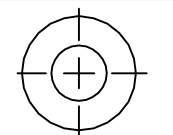

DECIMAL TOL.  
± 0.015 [0.38]

ANGULAR TOL.  
± 5°

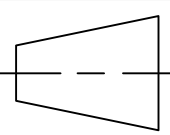

CBD SERIES

TITLE

SCALE

N.T.S.

DRAWN BY

M. ENEA

APPROVED BY

R. WILLIAMS

MS4016D

DATE

8-12-03

DRAWING NUMBER

SK5100

REV.

B