

SG50S009VCBR500

Product Details

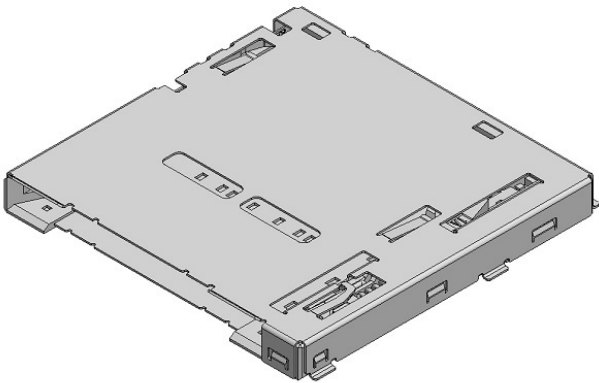

Features

Full-Size SD Card Connector, UHS-I Compatible Rugged, 9 pos., Push-push Type

Part Number	SG50S009VCBR500
Status	Active
Number of Positions	9 pos.
Rated Current	0.5 A
Rated Voltage	10 V
Connector Type	Rugged Full-Size SD Card Connector
Applicable Specifications	UHS-I
Card Ejection Method	Push-push Type
Card mis-insertion Prevention Mechanism	Yes
Card Detection Switch	Yes
PCB Mounting Method	Soldering (SMT)
PCB Boardlock Feature	Hold-down
PCB Mounted Height (mm)	3.15
Body Length (mm)	28.85
Body Breadth (mm)	29

Material of Contact	Copper alloy
Finish of Contact in Connecting Area	Gold plating over Nickel
Finish of Contact in Board mounting area	Gold plating over Nickel
Material of Housing	Synthetic resin
Cover Frame	Stainless steel
Finish of Contact in Board mounting area	Gold plating over Nickel
Contact Resistance	Signal: 100 milliohm max., Detect Switch: 1 ohm max.
Durability	10,000 times
Packaging Type	Embossed tape packaging
Mating Cycles (times)	Embossed tape packaging
Quantity in The Standard Packaging (pieces)	500 pieces/reel
RoHS compliant	10 substances (2011/65/EU, (EU)2015/863)
REACH compliant	240 substances (23/01/2024)

Notice

1. The values specified in this web site are only for reference. The products and their specifications are subject to change without notice. Contact our sales staff for further information before considering or ordering any of our products.
For purchase, a product specification must be agreed upon.
2. Users are requested to provide protection circuits and redundancy circuits to ensure safety of the equipment, and sufficiently review the suitability of JAE's products to the equipment.
3. The products presented in this web site are designed for the uses recommended below.
We strongly suggest you contact our sales staff when considering use of any of the products in any other way than the recommended applications or for a specific use that requires an extremely high reliability.
(1) Applications that require consultation:
 - * Please contact us if you are considering use involving a quality assurance program that you specify or that is peculiar to the industry, such as:

Automotive electrical components, train control, telecommunications devices (mainline), traffic light control, electric power, combustion control, fire prevention or security systems, disaster evention equipment, etc.

* We may separately give you our support with a quality assurance program that you specify, when you think of a use such as :

Aviation or space equipment, submarine repeaters, nuclear power control systems, medical equipment for life support, etc.

(2) Recommended applications include:

* Computers, office appliances, telecommunications devices (terminals, mobile units), measuring equipment, audiovisual equipment, home electric appliances, factory automation equipment, etc