

SERIES: MD-SP | **DESCRIPTION:** MINI DIN CONNECTOR

FEATURES

- vertical
- panel mount
- plastic mounting ears w/recess for hex nut



PART NUMBER KEY

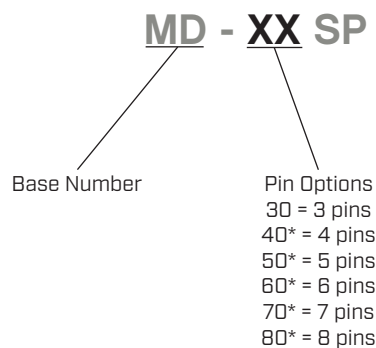

Note: *. Discontinued MD-40SP, MD-50SP, MD-60SP MD-70SP & MD-80SP models.

SPECIFICATIONS

parameter	conditions/description	min	typ	max	units
rated input voltage			100 12		Vac Vdc
rated input current	at 100 Vac at 12 Vdc			1 2	A A
contact resistance				30	mΩ
insulation resistance	at 250 Vdc	50			MΩ
voltage withstand	for 1 minute			250	Vac
insertion force				4.5	kg
withdrawal force		0.9		3	kg
operating temperature		5		80	°C
life			5,000		cycles
flammability rating	UL94V-0				
RoHS	yes				

MECHANICAL DRAWINGS

units: mm
tolerance: ±0.2 mm

ITEM	DESCRIPTION	MATERIAL	PLATING/COLOR
A	housing	NY6+FB (PA-1010C2)	
B	shell	brass	nickel
C	pins	phosphor bronze	silver
D	body	HIPS (PH-88)	

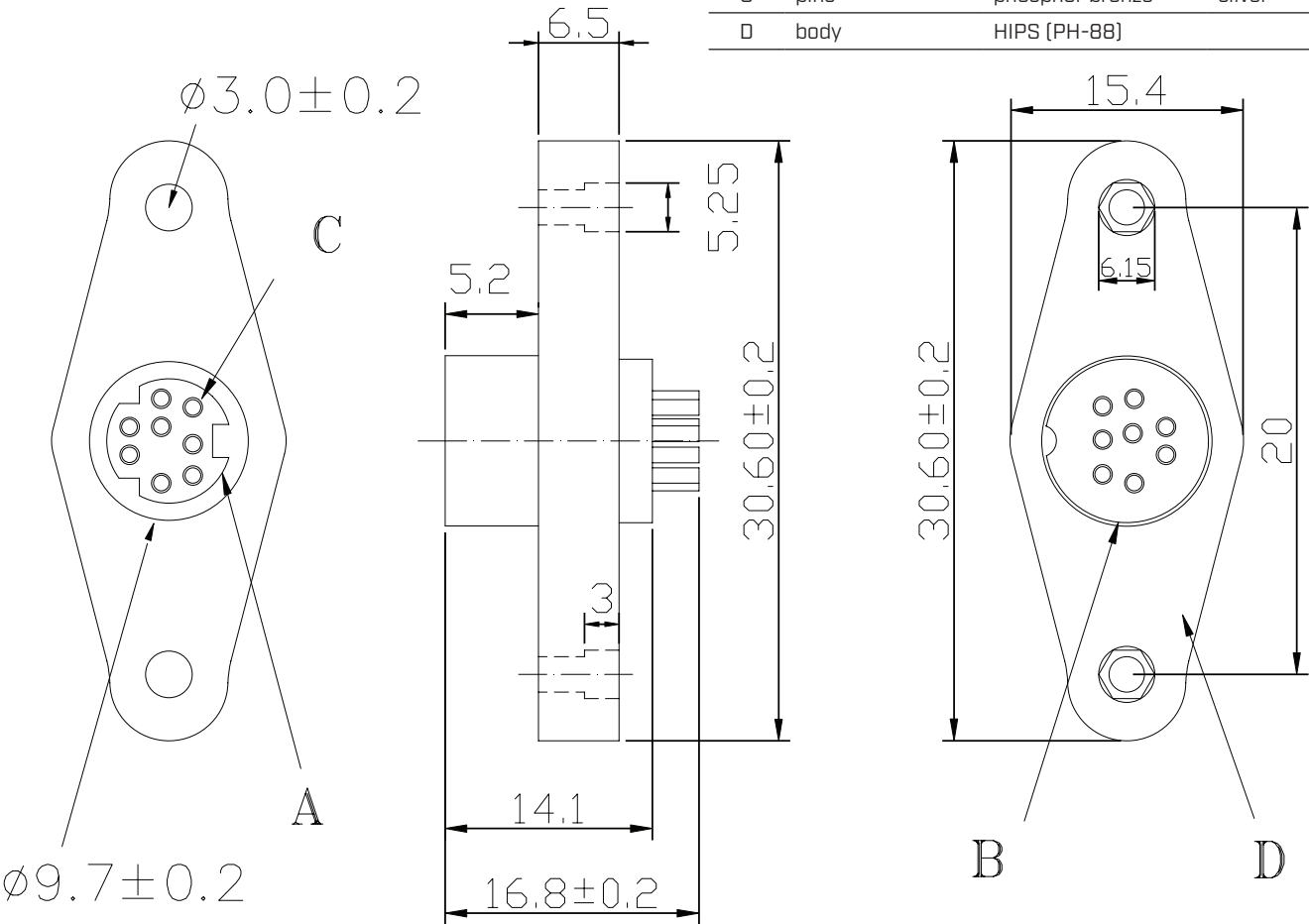

MD-30SP

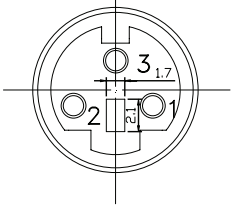

MD-40SP

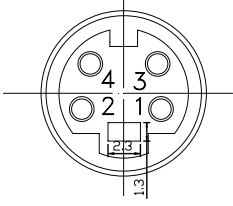

MD-50SP

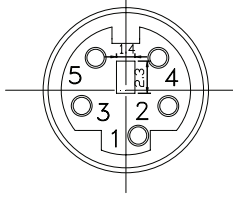

MD-60SP

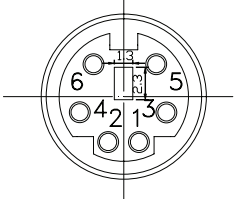

MD-70SP

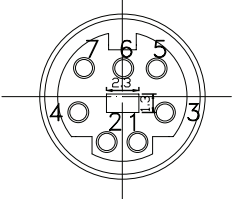

MD-80SP

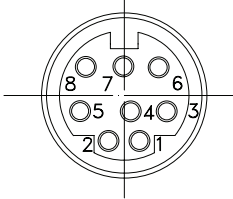

REVISION HISTORY

rev.	description	date
1.0	initial release	02/23/2006
1.01	new template applied	02/09/2012
1.02	updated datasheet	08/25/2017
1.03	brand update	02/19/2020
1.04	changed housing mold	07/09/2020
1.05	updated drawing	02/10/2022
1.06	logo, datasheet style update	08/05/2022
1.07	discontinued models MD-40SP, MD-50SP, MD-70SP & MD-80SP	09/26/2022
1.08	discontinued model MD-60SP	05/31/2023
1.09	CUI Devices rebranded to Same Sky	09/12/2024

The revision history provided is for informational purposes only and is believed to be accurate.



Same Sky offers a one (1) year limited warranty. Complete warranty information is listed on our website.

Same Sky reserves the right to make changes to the product at any time without notice. Information provided by Same Sky is believed to be accurate and reliable. However, no responsibility is assumed by Same Sky for its use, nor for any infringements of patents or other rights of third parties which may result from its use.

Same Sky products are not authorized or warranted for use as critical components in equipment that requires an extremely high level of reliability. A critical component is any component of a life support device or system whose failure to perform can be reasonably expected to cause the failure of the life support device or system, or to affect its safety or effectiveness.

[sameskydevices.com](https://www.sameskydevices.com)