

6

5

4

3

2

1

APPROVED: \_\_\_\_\_

DATE: \_\_\_\_\_ TITLE: \_\_\_\_\_

Rev

AWO #

Description

Date

Appr

-

RELEASED

8/16/21

D

D

C

C

B

B

A

A

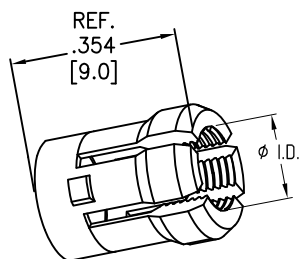

CABLE COLLET

MMI-POM-COL-XX

CABLE COLLET SIZE	
32	= 2.2mm ~ 3.2mm ID
42	= 3.2mm ~ 4.2mm ID
45	= 3.5mm ~ 4.5mm ID
52	= 4.2mm ~ 5.2mm ID
55	= 4.5mm ~ 5.5mm ID

## SPECIFICATIONS:

Material:

Brass, Natural Chrome plated

Environmental:

Lead free, RoHS compliant



UNLESS OTHERWISE SPECIFIED  
ALL DIMENSIONS ARE INCHES [MM]  
TOLERANCES: EXCEPT AS NOTED  
INCHES HOLES  
.X ± .10 Ø.X ± .10  
.XX ± .020 Ø.XX ± .015  
.XXX ± .015 Ø.XXX ± .010

APPROVALS		DATE
DRAWN	SS	8/16/21
CHECKED	SS	8/16/21
APPROVED		

**ADAM**  
**TECH**

909 Rahway Avenue,  
Union, NJ 07083  
Phone: 908-687-5000  
Fax: 908-687-5710

TITLE  
PUSH-PULL METAL COLLET FOR MALE  
METAL PLUG SIZE 0, IP50

SIZE X	PART NO. MMI-POM-COL-XX	REV. -
REF: SXXXXXX	SCALE: NTS	SHEET 1 OF 1

6

5

4

3

2

1