

THIS PRODUCT MANUFACTURED
WITH LEAD-FREE PROCESSING

DESIGNED & DIMENSIONED
IN MILLIMETERS[INCHES]

DO NOT
SCALE FROM
THIS PRINT

TABLE 1			
ITEM	COMPONENT	-H	-GF
1	FERRULE	TNC-FER-003-F	TNC-FER-003-F
2	PIN	SMA-PIN-010-H	SMA-PIN-010-G
3	SUB ASSEMBLY	SUB-SMA-P-C-F-ST-C10	SUB-SMA-P-C-F-ST-C10

SMA-P-C-XX-ST-C10

GENDER
-P: PLUG

TERMINATION
-C10: RG58 CABLE

TYPE
-C: CABLE

ORIENTATION
-ST: STRAIGHT

PLATING SPECIFICATION
[C] -H: HEAVY GOLD/NICKEL
30µ" AU / 50µ" NI MIN ON CENTER CONTACT,
3µ" AU / 50µ" NI MIN ON OUTER CONTACT,
-GF: GOLD/FLASH GOLD/NICKEL
10µ" AU / 50µ" NI MIN ON CENTER CONTACT,
3µ" AU / 50µ" NI MIN ON OUTER CONTACT,

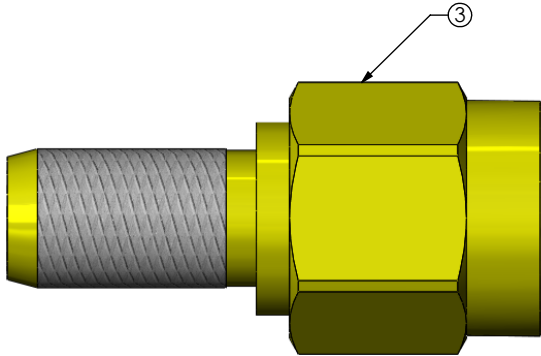
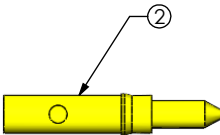
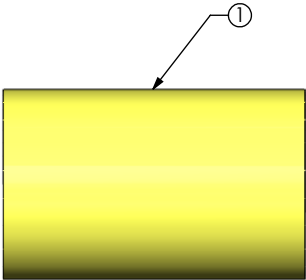

NOTES: [C]

- 1. REPRESENTS A CRITICAL DIMENSION.
- 2. NOTE DELETED.
- 3. PRODUCT TO BE PACKAGED PER PACKAGING STANDARD CO-HD-WI-3040M.
- 4. NOTE DELETED.
- 5. NOTE DELETED.
- 6. NOTE DELETED.

UNLESS OTHERWISE SPECIFIED,
DIMENSIONS ARE IN
MILLIMETERS [INCHES].
TOLERANCES ARE:

DECIMALS	ANGLES
.X: ±0.3 [.01]	5 °
.XX: ±0.13 [.005]	
.XXX: ±0.051 [.0020]	

MATERIAL: DO NOT SCALE DRAWING

BODY, FERRULE, NUT: BRASS
CONTACT: BRASS
DIELECTRIC: PTFE
GASKET: SILICONE
RING: STAINLESS STEEL

PROPRIETARY NOTE

THIS DOCUMENT CONTAINS INFORMATION
CONFIDENTIAL AND PROPRIETARY TO
SAMTEC, INC. AND SHALL NOT BE REPRODUCED
OR TRANSFERRED TO OTHER DOCUMENTS OR
DISCLOSED TO OTHERS OR USED FOR ANY
PURPOSE OTHER THAN THAT WHICH IT WAS
OBTAINED WITHOUT THE EXPRESSED WRITTEN
CONSENT OF SAMTEC, INC.

SHEET SCALE: 3:1

520 PARK EAST BLVD., NEW ALBANY, IN 47150
PHONE: 812-944-6733 FAX: 812-948-5047
e-Mail: info@SAMTEC.com code: 55322

DESCRIPTION:
SMA 50 OHM STRAIGHT PLUG FOR RG58

DWG. NO.
SMA-P-C-XX-ST-C10

BY: ALVIN W 08/05/2010 SHEET 1 OF 2

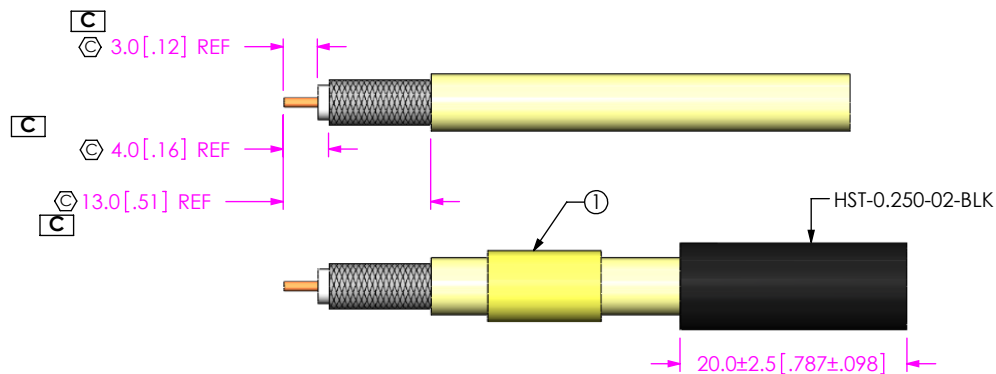

IN PROCESS 1
STRIP AND TIN INNER CONDUCTOR

IN PROCESS 2
ADD HEAT SHRINK TUBE AND FERRULE

IN PROCESS 3
FLARE SHIELD

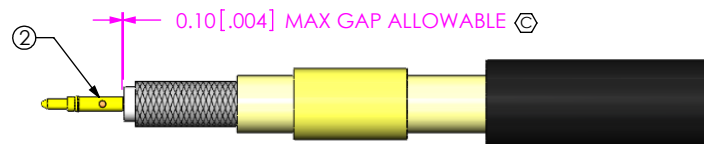

IN PROCESS 4
SOLDER SIGNAL PIN

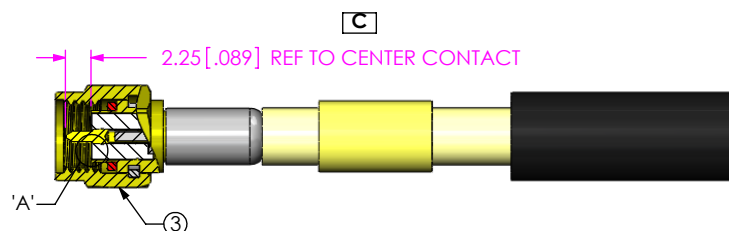

IN PROCESS 5
ADD SUB-SMA-P-C-X-ST-C10

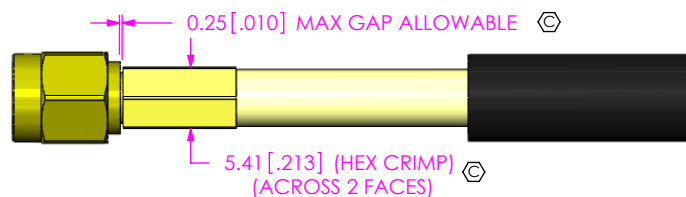

IN PROCESS 6
CRIMP FERRULE
(USE RF CRIMP HAND TOOL # CAT-HT-126667-21 OR EQUIVALENT)



IN PROCESS 7
APPLY HEAT SHRINK TUBING

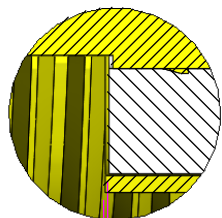

DETAIL 'A'
SCALE TO: 1

PROPRIETARY NOTE

THIS DOCUMENT CONTAINS INFORMATION CONFIDENTIAL AND PROPRIETARY TO SAMTEC, INC. AND SHALL NOT BE REPRODUCED OR TRANSFERRED TO OTHER DOCUMENTS OR DISCLOSED TO OTHERS OR USED FOR ANY PURPOSE OTHER THAN THAT WHICH IT WAS OBTAINED WITHOUT THE EXPRESSED WRITTEN CONSENT OF SAMTEC, INC.

DO NOT SCALE DRAWING

SHEET SCALE: 3:2

samtec

520 PARK EAST BLVD, NEW ALBANY, IN 47150
PHONE: 812-944-6733 FAX: 812-948-5047
e-Mail: info@SAMTEC.com code: 55322

DESCRIPTION:
SMA 50 OHM STRAIGHT PLUG FOR RG58

DWG. NO.
SMA-P-C-XX-ST-C10

BY: ALVIN W 08/05/2010 SHEET 2 OF 2