

G series

Slide switches • telecom grade



DISTINCTIVE FEATURES

Panel and PC mount models

6 actuator lengths

Wide variety of contact materials



ELECTRICAL SPECIFICATIONS

- Max. current/voltage rating with resistive load :
 - silver contacts (codes 1 or 2) : 3 A 30 VDC
 - gold plated brass contacts (code 0) : 0.4 VA 20 VAC or DC max.
- Initial contact resistance : 10 mΩ
- Insulation resistance : 1,000 MΩ min.
- Dielectric strength : 1,000 Vrms 50 Hz min.
- Electrical life with resistive load :
 - silver contacts (codes 1 or 2) : 2 positions : 40,000 cycles;
3 positions : 20,000 cycles
 - gold plated brass contacts (code 0) : 60,000 cycles (0.4VA max.)



GENERAL SPECIFICATIONS

- Travel : 2.20 mm (.086), except on model **GN3...** : 2.60 mm (.102)
- Operating temperature : -30 °C to +85 °C (-22 °F to +185 °F)
- Recommended soldering : 300 °C (572 °F) 5 sec. max.



MATERIALS

- Case : PES
- Actuator : polyamide, glass filled
- Cover : stainless steel
- Contacts
 - 0 : brass, gold plated
 - 1 : silver
 - 2 : silver, gold plated
 - 5 : special contact, lower rating, minimum quantity : consult factory
- Terminal seal : epoxy

APEM products may be recycled at end-of-life for the re-claiming of valuable metal components.

The company reserves the right to change specifications without notice.

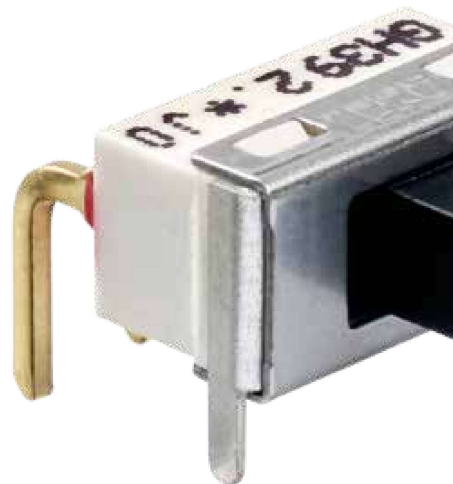

G series

Slide switches • telecom grade



PANEL CUT-OUT

SOLDER LUG MODEL

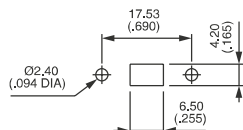

TERMINALS

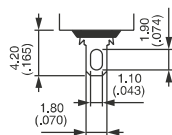

Solder lugs

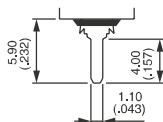

Straight PC



ELECTRICAL FUNCTIONS

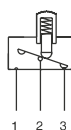

PCB MOUNTING

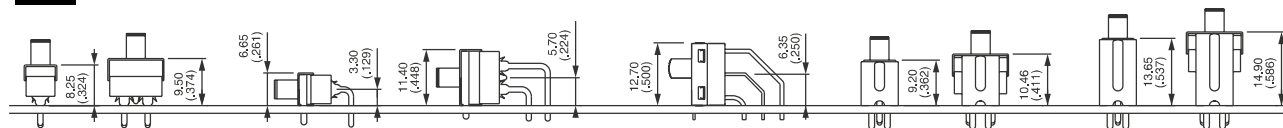



BUILD YOUR PART NUMBER

BASIC PART NUMBER				
G				
SERIES	ACTUATORS	NUMBER OF POLES	ELECTRICAL FUNCTIONS	TERMINALS
	C 3.50 mm (.137) H 5.10 mm (.200) Standard L 6.40 mm (.251) B 7.65 mm (.301) E 9.10 mm (.358) N 9.50 mm (.374)	3 Single pole 4 Double pole	6 ON - ON 9 ON OFF ON	S0 Solder lugs P0 Straight PC W0 Right angle, horizontal WW Right angle, vertical Y0 Straight PC with short bracket Y4 Straight PC with tall bracket

Types L, B and E for single pole models only.

OPTIONS		
CONTACT AND TERMINAL MATERIALS	SPECIAL OPTIONS 1	SPECIAL OPTIONS 2
0 Brass, gold plated 1 Silver 2 Silver, gold plated 5 Special contact, lower rating	00 Standard model 10 Switch without ground plate 11 10.35 mm (.407) PC terminals 12 Same as 11, without ground plate	00 No epoxy seal 01 Epoxy sealed terminals 10 Extended terminals 11 Same as 10, with epoxy seal



ABOUT THIS SERIES

On the following pages, you will find successively basic part numbers of switches and options in the same order as in above chart.

Notice : please note that not all combinations of above numbers are available. Refer to the following pages for further information.

G series

Slide switches • telecom grade

SOLDER LUG TERMINALS



Single pole Double pole

GH36S0	GH46S0	ON	-	ON
GH39S0	GH49S0	ON	OFF	ON

STRAIGHT PC TERMINALS



Single pole Double pole

GH36P0	GH46P0	ON	-	ON
GH39P0	GH49P0	ON	OFF	ON

RIGHT ANGLE TERMINALS - HORIZONTAL



Single pole Double pole

GH36W0	GH46W0	ON	-	ON
GH39W0	GH49W0	ON	OFF	ON

RIGHT ANGLE TERMINALS - VERTICAL



Single pole Double pole

GH36WW	GH46WW	ON	-	ON
GH39WW	GH49WW	ON	OFF	ON

Shown with standard actuator (type H)

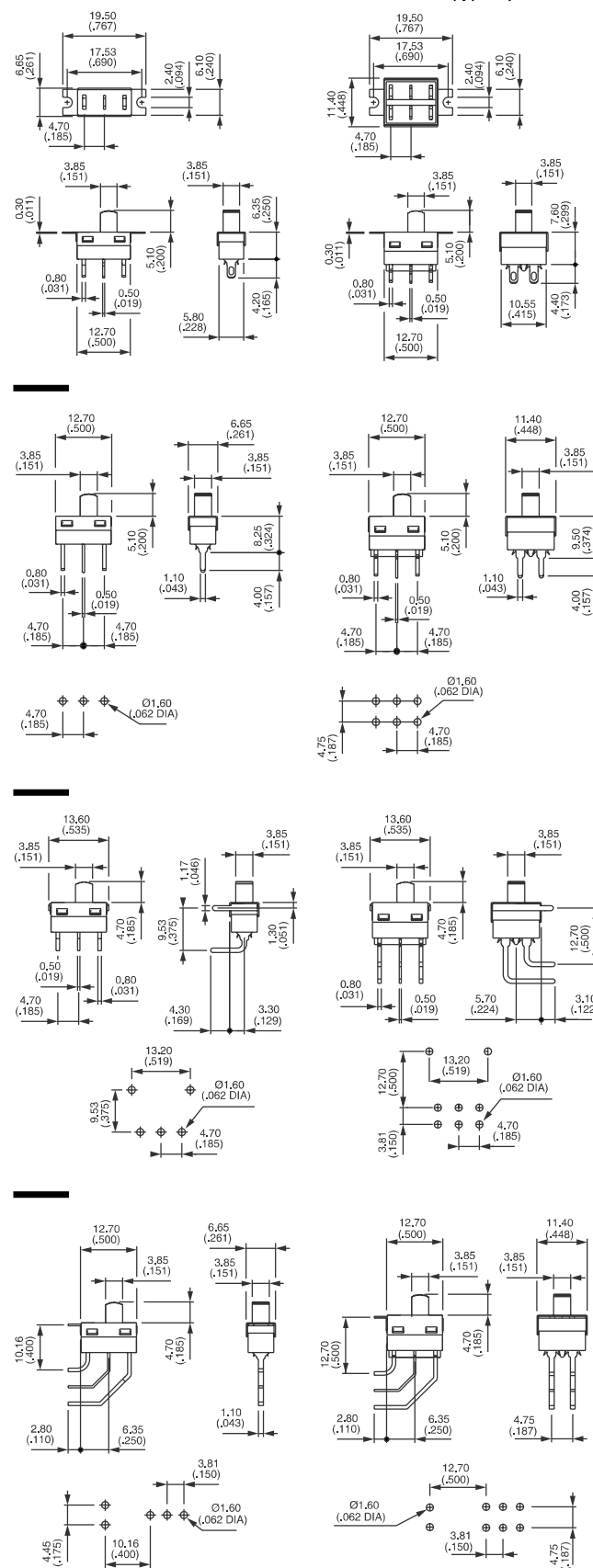

STRAIGHT PC TERMINALS SHORT BRACKET : Y0



Single pole	Double pole			
GH36Y0	GH46Y0	ON	-	ON
GH39Y0	GH49Y0	ON	OFF	ON

STRAIGHT PC TERMINALS TALL BRACKET : Y4



Single pole	Double pole			
GH36Y4	GH46Y4	ON	-	ON
GH39Y4	GH49Y4	ON	OFF	ON

Shown with standard actuator (type H)

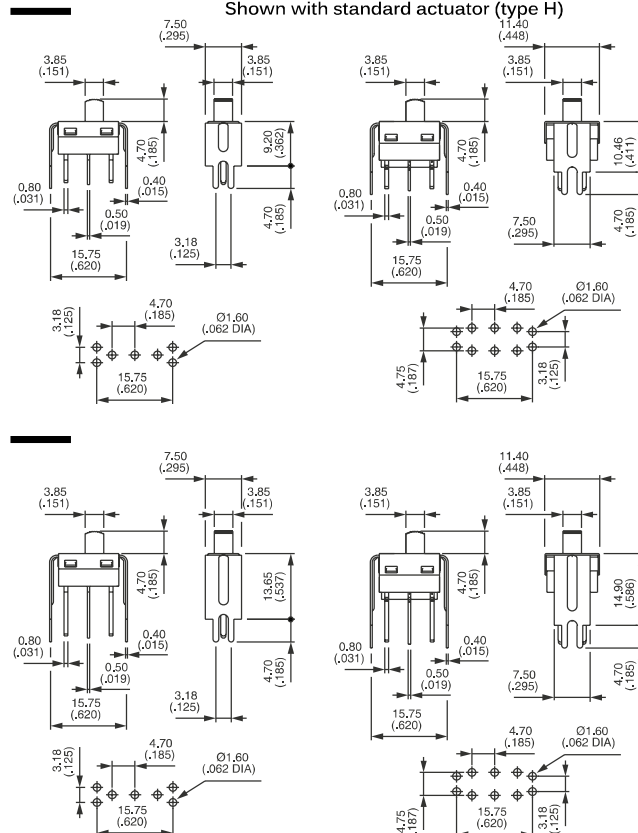

ACTUATORS

For a different actuator, replace second digit (H) of basic part number with one of the following codes.

- ⚠ Dimensions below are for solder lug (S0) and straight terminals (P0) models.
For other models (WO - WW - Y0 - Y4), height is less 0.4 mm (.015).



C



H
Standard



L *



B *



E *



N

* For single pole only

G series

Slide switches • telecom grade

CONTACT AND TERMINAL MATERIALS

BASIC P/N

- 0 Brass, gold plated
- 1 Silver
- 2 Silver, gold plated
- 5 Special contact, lower rating, minimum quantity : consult factory

SPECIAL OPTIONS 1

BASIC P/N

- 00 Standard switch as presented on previous pages
- 10 Switch without ground plate
For right angle only (W0 and WW models)
- 11 10.35 mm (.407) long PC terminals
- 12 10.35 mm (.407) long PC terminals without ground plate



10

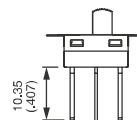

11

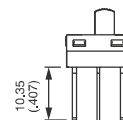

12

SPECIAL OPTIONS 2

BASIC P/N

- 00 No epoxy seal
- 01 Epoxy sealed terminals
(compulsory on solder lug models)
- 10 Extended terminals
For vertical right angle (WW models)
- 11 Extended terminals as above, with epoxy seal

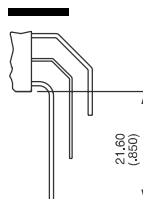

10

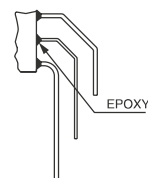

11