

APPROVED: \_\_\_\_\_

DATE: \_\_\_\_\_ TITLE: \_\_\_\_\_

Rev	AWO #	Description	Date	Appr
-		RELEASED	3/9/21	
A		UPDATE SPEC.	6/21/21	WX/RC

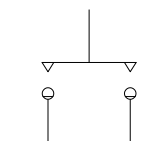
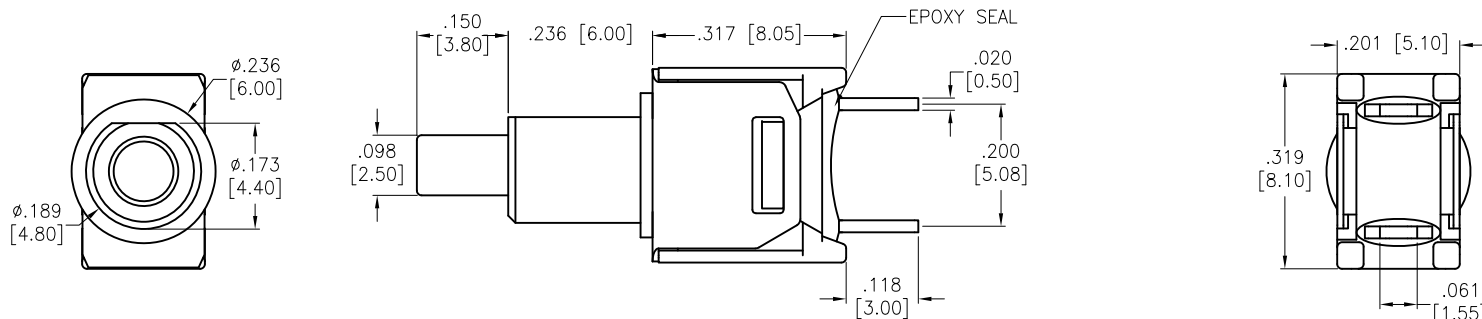

CIRCUIT DIAGRAM  
(SPST) OFF-MOM

# SPECIFICATIONS:

## Material:

Movable Contact: Copper Alloy, Silver Plated

Terminal: Copper Alloy, Silver Plated

## Electrical:

Rating: 1 Amps with resistive load @ 125VAC or 28VDC

Contact resistance: 20 mΩ max

Insulation resistance: 1,000 Mohms min

Dielectric withstanding voltage: 1,500V RMS @Sea level

Temperature Rating:

Operating temperature: -30°C to +85°C

Environmental:

Lead free, RoHS compliant



UNLESS OTHERWISE SPECIFIED  
ALL DIMENSIONS ARE INCHES [MM]  
TOLERANCES: EXCEPT AS NOTED  
INCHES HOLES

.X	± .10	Ø.X	±.10
.XX	± .020	Ø.XX	±.015
.XXX	± .015	Ø.XXX	±.010

APPROVALS DATE

DRAWN	WX	3/9/21
CHECKED	AC	3/9/21
APPROVED		

**ADAM**  
**TECH**

909 Rahway Avenue,  
Union, NJ 07083  
Phone: 908-687-5000  
Fax: 908-687-5710

TITLE  
SUB-MINIATURE PUSHBUTTON SWITCH,  
OFF-MOMENTARY, SPST, SILVER PLATED, SOLDER TYPE

SIZE X	PART NO. SW-PB9-BB00AQE-5	REV. A
REF: S00198T	SCALE: NTS	SHEET 1 OF 1