

# SUBRACKS

## HORIZONTAL RAILS HeiPac Vario / Vario EMC

### Horizontal rail Vario V 1, front



To accommodate guide rails and for the attachment of front panels

- Front projection 2.5 mm corresponding to IEC 60 297-3-101
- HP pitch pattern of holes for the precise installation of guide rails
- M4 thread on end face
- Straight-through core hole
- Horizontal rail 192 HP without machining on the end faces. Suitable for cutting to length

#### Material

Extruded aluminium section

#### Surface finish

Clear-chromated

Usable width (HP)	Packs of	Order No. unprinted	Order No. printed
4 (left)	1	<b>3684.592</b>	-
4 (right)	1	<b>3684.955</b>	-
8 (left)	1	<b>3684.593</b>	-
8 (right)	1	<b>3684.956</b>	-
12	1	<b>3684.594</b>	-
16	1	<b>3684.595</b>	-
20	1	<b>3684.596</b>	-
21	1	<b>3685.985</b>	-
40	1	<b>3684.960</b>	-
42	1	<b>3684.560</b>	<b>9921.788<sup>3)</sup></b>
63	1	<b>3684.561</b>	-
84	1	<b>3684.562</b>	<b>9921.789<sup>3)</sup></b>
84	2	<b>3685.267<sup>1)</sup></b>	-
192	1	<b>3688.000<sup>2)</sup></b>	-

<sup>1)</sup> Including 4 assembly screws

<sup>2)</sup> Anodised

<sup>3)</sup> with HP pattern printing

#### + Also required

Assembly screws M4 x 12  
Packs of 100, order no. 3654.300  
see page 202

#### + Accessories

Threaded inserts, packs of 1, order no. 3684.610  
see page 144

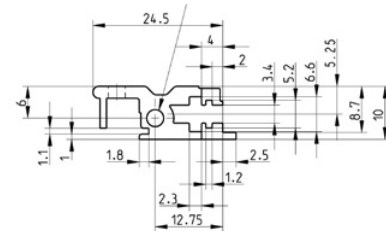
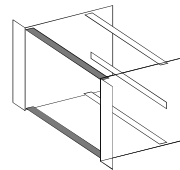

### Horizontal rail Vario V 2, front, with double screw fastening



To accommodate guide rails and for the attachment of front panels. The double screw fastening ensures a high level of stability even under extreme loads.

- Front projection 2.5 mm corresponding to IEC 60 297-3-101
- HP pitch pattern of holes for the precise installation of guide rails
- M4 thread on end face
- Straight-through core hole
- Load test to DIN EN/IEC 61 587-1, requirement level SL1
- Shock and vibration tests undertaken as per IEC 61 373 (DIN EN 50 155), Category 1, Class B

#### Material

Extruded aluminium section

#### Surface finish

Clear-chromated

Usable width (HP)	Packs of	Order No. unprinted	Order No. printed
84	1	<b>9908.721</b>	<b>9921.793<sup>1)</sup></b>

<sup>1)</sup> with HP pattern printing

#### + Also required

Assembly screws M4 x 12  
Packs of 100, order no. 3654.300  
see page 202

#### + Accessories

Threaded inserts, packs of 1  
order no. 3684.610  
see page 144

