

SERPAC
Electronic Enclosures

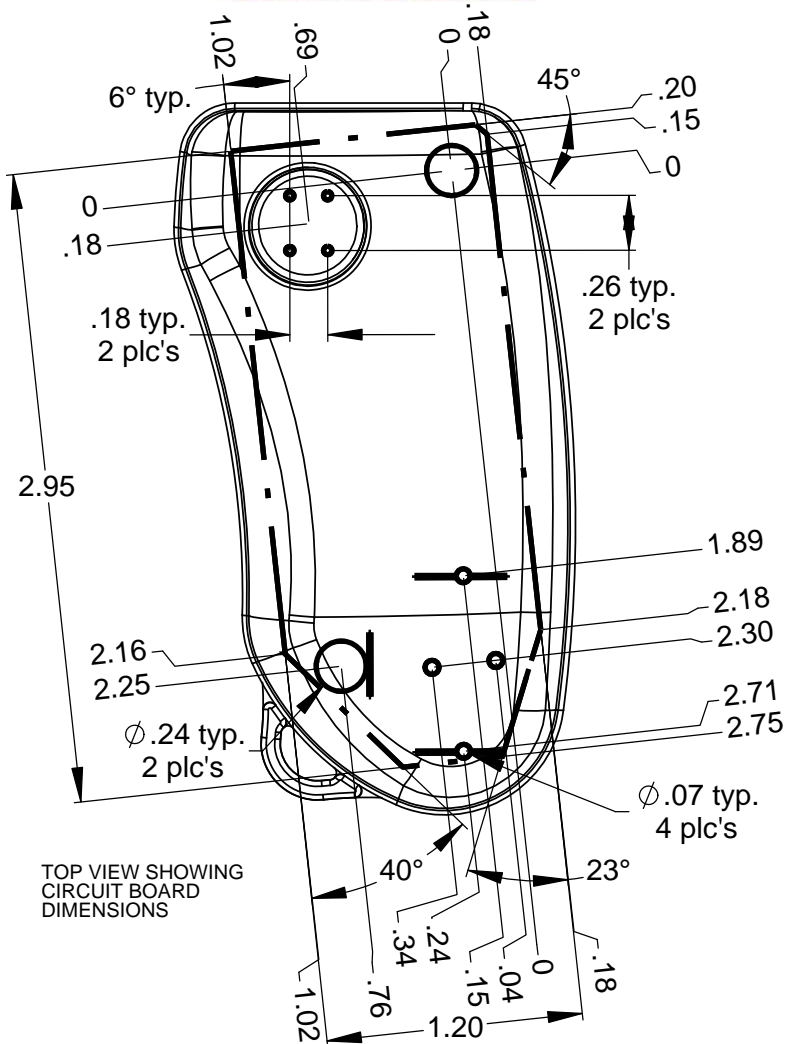

TOP VIEW SHOWING
CIRCUIT BOARD
DIMENSIONS

NOTES:

- 1) Serpac Provides the following components:
Top, Bottom, Button Membrane, 9mm keying and (2) #2 Screws.
All components are shipped unassembled.
- 2) The switches characteristics recommended for this enclosure are:
 - 4.3 mm in height from mounting surface to top of push plate.
 - Operating force recommended is 2.2 N or higher.
- 3) For battery contacts use:
 - for Coin battery Keystone 3003 positive and 2990 negative

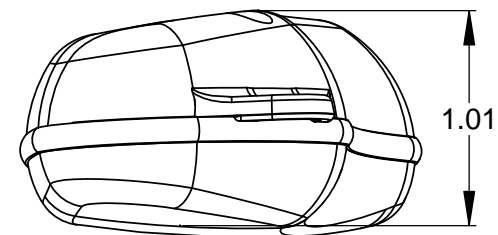
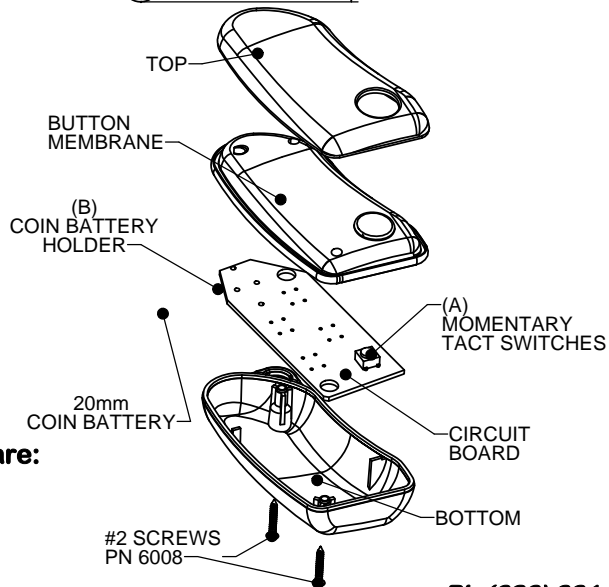
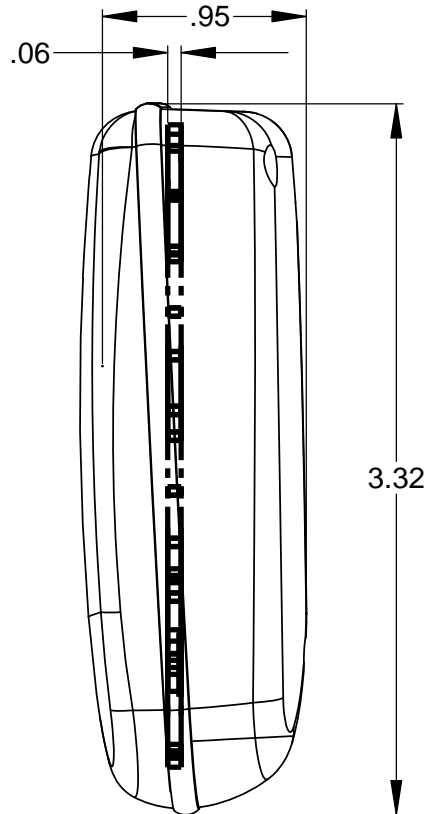

ALL DIMENSIONS ARE $\pm .010"$ 7/21/2013
2009 Wright Ave., La Verne, CA 91750
17 Fx: (626) 331-8584 www.serpac.com

Ph:(626) 331-0517 Fx: (626) 331-8584 www.serpac.com