

SERPAC **CA8B2** (2 button option)
Electronic Enclosures

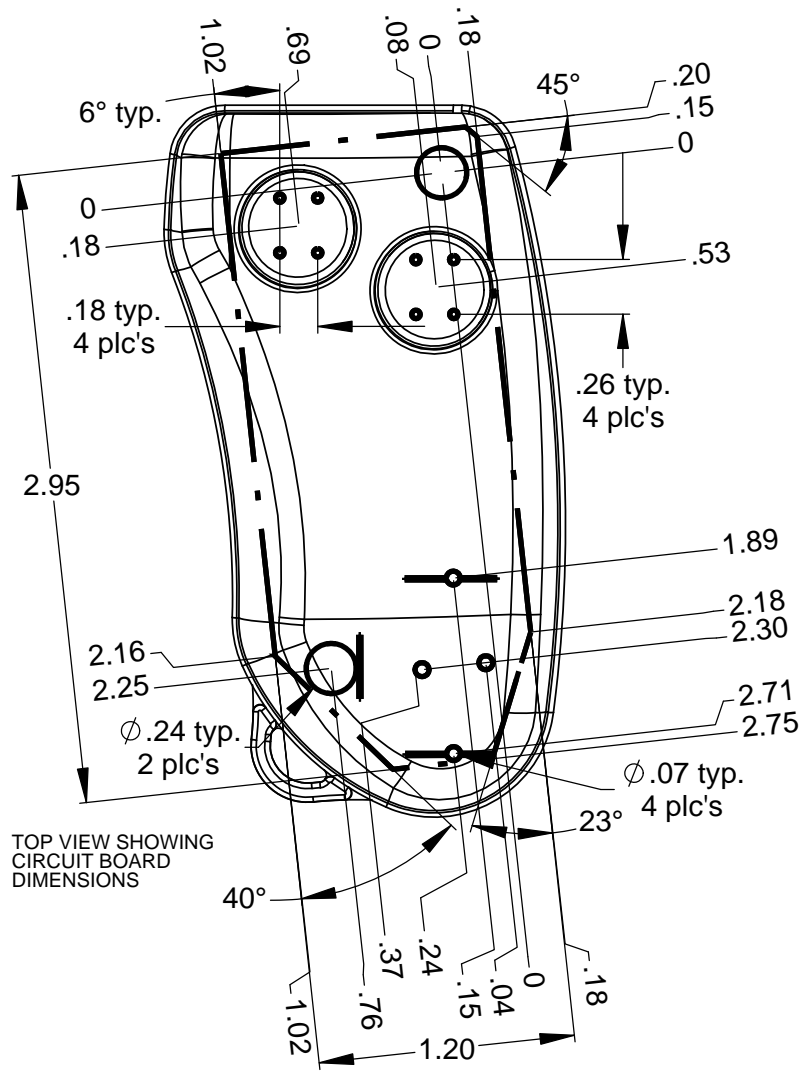

TOP VIEW SHOWING
CIRCUIT BOARD
DIMENSIONS

NOTES:

- 1) Serpac Provides the following components:
Top, Bottom, Button Membrane, 9mm keying and (2) #2 Screws.
All components are shipped unassembled.**

- 2) The switches characteristics recommended for this enclosure are:**
- 4.3 mm in height from mounting surface to top of push plate.
 - Operating force recommended is 2.2 N or higher.

- 3) For battery contacts use:**
- for Coin battery **Keystone 3003 positive and 2990 negative**

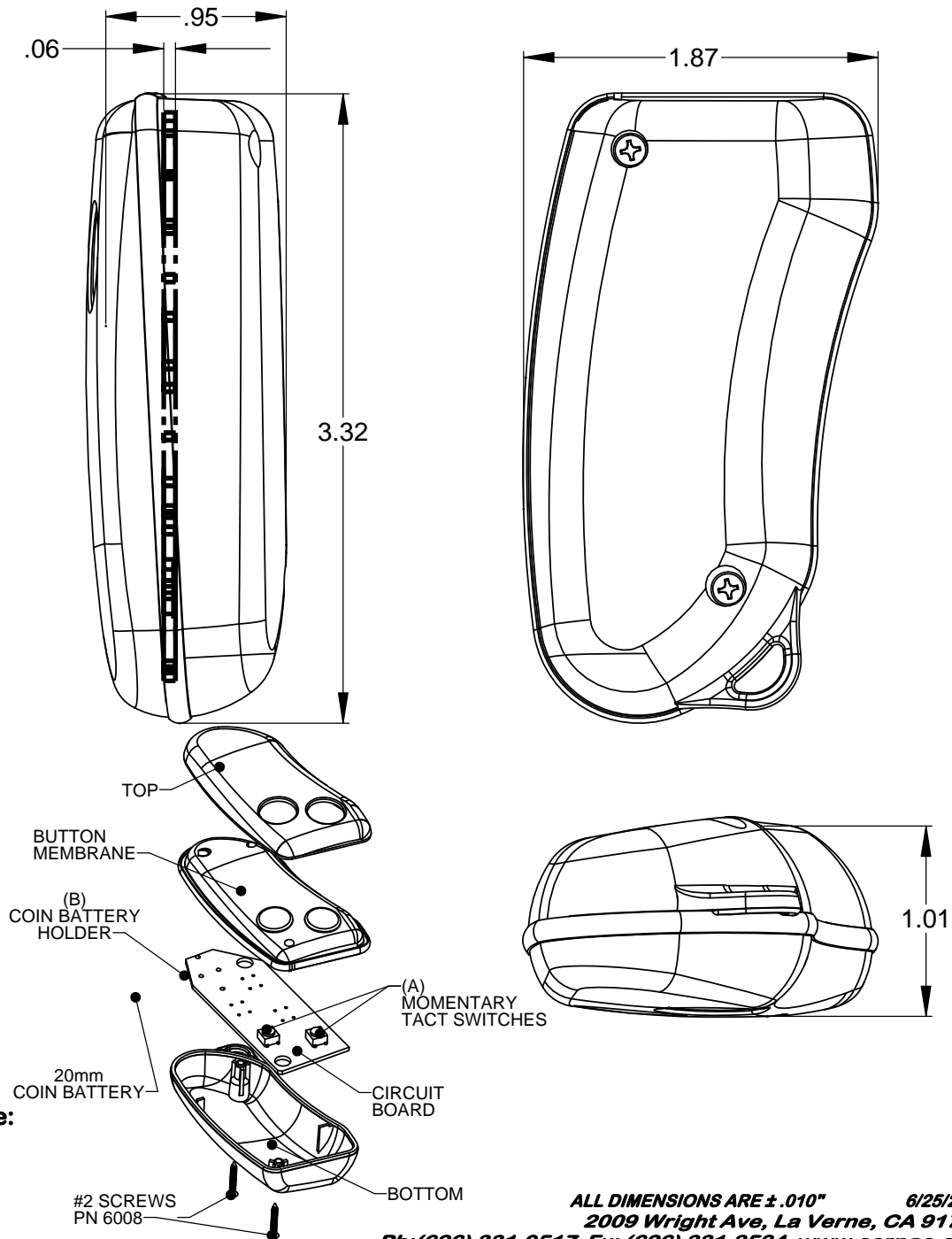

ALL DIMENSIONS ARE $\pm .010"$ 6/25/2013
2009 Wright Ave, La Verne, CA 91750
17 Fx: (626) 331-8584 www.serpac.com