

V2.1

3DMAKERPRO

store.3dmakerpro.com

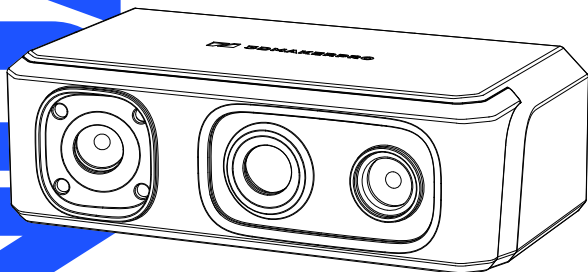

# SEAL & SEAL Lite

3DMAKERPRO

f @3DMakerProCares

@official3DMakerPro

@3DMakerPro

<https://store.3dmakerpro.com/>

service@3dmakerpro.com

JimuMeta

f @JimuMeta

@JimuMeta

<https://www.jimumeta.com/>

service@jimumeta.com

Download latest **JMStudio** from

<https://forum.jimumeta.com/home/help/download.html>

Get latest **Manual** from

<https://forum.jimumeta.com/home/help/manual.html>



3D MAKERPRO LIMITED

# Hardware connection

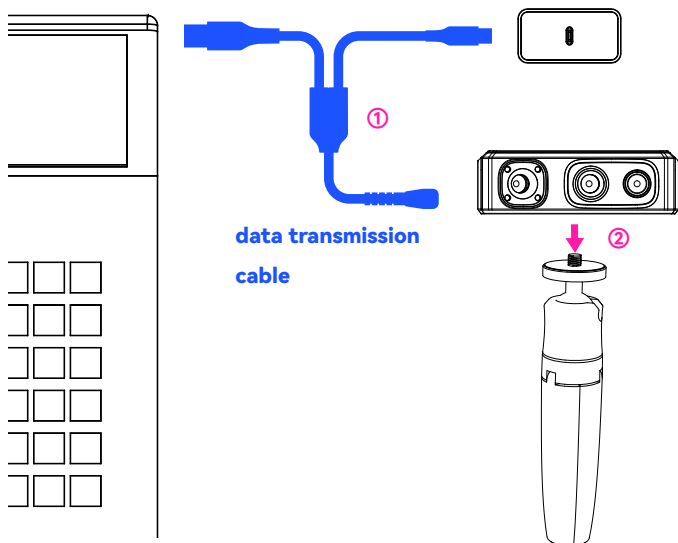

① Plug the longer "L" type plug of the device cable into the scanner, another two shorter ends into the PC USB port and power adapter respectively.

② Connect the tripod to the scanner body by inserting the screw thread on the top into the screw hole in the another and tighten it clockwise.

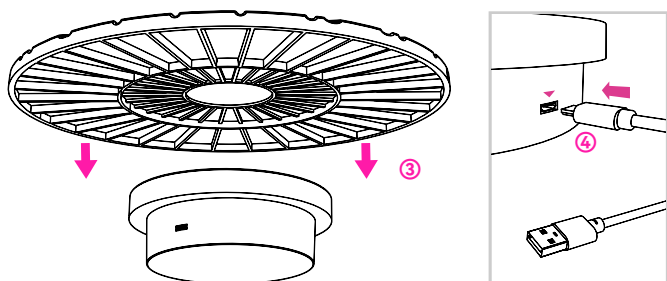

③ Place the Turntable Surface on top of the turntable.

④ Plug the Micro USB end of the turntable cable into the turntable and the USB end to a power source.

# Packing list

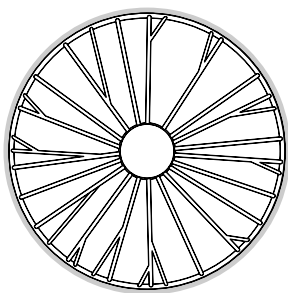

Turntable Surface<sup>1</sup>

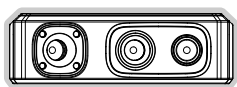

scanner body

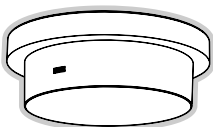

turntable<sup>2</sup>



power adapter

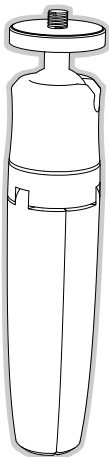

tripod<sup>3</sup>



turntable cable<sup>4</sup>



data transmission cable

\* Product images are for illustrative purposes only.

\* <sup>1234</sup>Not included in the Standard Combo.

## Operating System Requirement



Minimum	Intel Core i5 8th, 16GB RAM, MX250 GPU with 2GB VRAM
Recommended	Intel Core i7 8th, 16GB RAM, NVDIA1060 GPU with 4GB VRAM