

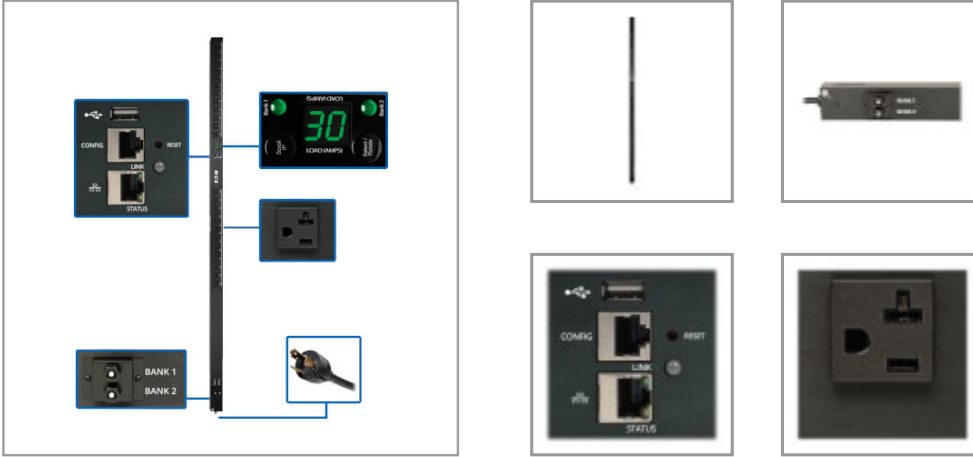

Powering Business Worldwide

2.9kW Single-Phase Monitored PDU with LX Platform Interface, 120V Outlets (24 5-15/20R), L5-30P Plug, 0U Vertical, TAA

MODEL NUMBER: PDUMNV30LX



2.9kW vertical PDU distributes and monitors single-phase power in an IT or industrial environment. Built-in Java-free network interface helps you remotely monitor load levels to prevent overloads that cause downtime.

Description

The PDUMNV30LX 2.9kW Single-Phase Monitored PDU provides real-time remote monitoring of voltage, frequency and load levels via built-in network connection. Recommended for IT and industrial applications, the vertical PDU features 24 NEMA 5-15/20R outlets with included cord retention brackets to prevent cables from becoming accidentally disconnected. A 10-ft. (3.05 m) cord with NEMA L5-30P plug connects the PDU to a compatible AC power source, generator or protected UPS.

The built-in Java-free HTML5-based LX Platform network interface enables full remote access for PDU status monitoring and email notifications via secure web browser, SNMP, telnet or SSH. It supports 10/100 Mbps auto-sensing for optimum communication with an Ethernet network. Optional EnviroSense2 modules (sold separately) provide a variety of environmental monitoring capabilities. Protocols supported include IPv4, IPv6, HTTP, HTTPS, SMTP, SNMPv1, SNMPv2, SNMPv3, telnet, SSH, FTP, DHCP and NTP.

A digital ammeter allows you to monitor power consumption for both breakered load banks, as well as the total load to ensure they remain well below maximum capacity with no danger of overload. The PDU mounts in 0U of space in EIA-standard 19-inch racks using the included toolless mounting buttons or the included rack-mounting brackets. Use the included PDUMVROTATEBRKT kit to install the unit with outlets facing the rear for better airflow or equipment access.

Features

Distributes and Monitors Network-Grade AC Power

- 2.9kW 120V 24A monitored rack PDU (rPDU) with single-phase input
- NEMA L5-30P with 10-ft. (3.05 m) cord connects to compatible AC power source
- Firmware upgrades support future product enhancements

24 NEMA 5-15/20R Outlets Distribute Power

- Cord retention brackets prevent cables from becoming accidentally disconnected

Digital Ammeter

- Reports power consumption for both breakered load banks, plus total output current

Highlights

- 2.9kW 120V single-phase monitored 0U PDU
- 24 NEMA 5-15/20R outlets with cord retention brackets
- Pre-installed WEBCARDLX with latest version of PADM20 for enhanced remote management
- Digital ammeter for on-site load monitoring in real time
- NEMA L5-30P input with 10-ft. (3.05 m) AC power cord

Package Includes

- PDUMNV30LX 2.9kW Single-Phase Monitored PDU
- Built-in LX Platform interface
- Configuration cable
- (24) Cable ties
- (2) Cord retention brackets
- Rack-mounting hardware
- PDUMVROTATEBRKT mounting bracket accessory
- Owner's manual



Powering Business Worldwide

- Supports IP-address self-ID
- Rotates 180° for easy reading at either angle

Built-In LX Platform Interface

- Pre-installed WEBCARDLX with the latest version of PowerAlert Device Manager firmware (PADM20) provides enhanced remote management capabilities
- PADM20 and PowerAlert Element Manager (PAEM) form a powerful tool for expanding maintenance functions in large installations, including firmware update checks and backup and restoration of device configurations
- Supports 10/100 Mbps auto-sensing for communication with an Ethernet network
- Optional EnviroSense2 modules (sold separately) provide a variety of environmental monitoring capabilities
- No Java required

Broad Communications Compatibility

- Supports IPv4, IPv6, HTTP, HTTPS, SMTP, SNMPv1, SNMPv2, SNMPv3, telnet, SSH, FTP, DHCP and NTP
- Supports automatic and manual assignment of IP address

Easy 0U Installation in EIA-Standard 19 in. Racks

- Mounts vertically using included toolless buttons or rack-mounting brackets
- Included PDUMVROTATEBRKT allows mounting with rear-facing outlets

TAA-Compliant

- Compliant with the Federal Trade Agreements Act (TAA) for GSA Schedule purchases

Specifications

| OVERVIEW | |
|--------------------------------|-----------------------------------|
| UPC Code | 037332203359 |
| PDU Type | Monitored |
| INPUT | |
| Input Phase | Single-Phase |
| PDU Input Voltage | 120 |
| Recommended Electrical Service | Single-phase 30A 120V service |
| Maximum Input Amps | 24 |
| Maximum Input Amps Details | Agency de-rated to 24A continuous |
| PDU Plug Type | NEMA L5-30P |
| Input Cord Length (ft.) | 10 |
| Input Cord Length (m) | 3.05 |
| OUTPUT | |



Powering Business Worldwide

| | |
|--|--|
| Output Capacity Details | 2.88kW (120V) / 24A total capacity; 20A max per breakered load bank; 16A max per outlet |
| Frequency Compatibility | 50 / 60 Hz |
| Output Receptacles | (24) 5-15/20R |
| Output Nominal Voltage | 120V |
| Overload Protection | Two 20A breakers protect 12 outlets each |
| USER INTERFACE, ALERTS & CONTROLS | |
| Front Panel LCD Display | Digital meter reports PDU output current in amps, Scroll IP-address information; Display can be rotated 180 degrees for installation with the input cable at the top |
| Switches | Press the SCROLL IP button and release to display the configured IP address in 2 digit intervals; Press the SELECT / ROTATE button and release after one second to advance the local display power power consumption for the 3 reported segments: Bank 1, Bank 2 and Banks 1+2; Press the SELECT / ROTATE button and release after two seconds to rotate the display 180 degrees |
| LED Indicators | Front panel LEDs indicate which loading segment the digital LCD current display is reporting; Bank 1 LED indicates the meter is reporting load level for outlets 1-12; Bank 2 LED indicates the meter is reporting load level for outlets 13-24; Both LEDs lighted indicates the meter is reporting load level for all outlets combined |
| Current Measurement Accuracy (Amps) | +/-1% |
| Voltage Measurement Accuracy (Volts) | +/-1% |
| Power Measurement Accuracy (Watts) | +/-1% |
| SURGE / NOISE SUPPRESSION | |
| Automatic Shut-Off | No |
| PHYSICAL | |
| Material of Construction | Metal |
| Rack Height | 0U |
| Form Factors Supported | 0U vertical rackmount installation supported with included mounting brackets; supports toolless mounting in button-mount compatible racks |
| PDU Form Factor | Vertical (0U) |
| Shipping Dimensions (hwd / in.) | 5.00 x 6.30 x 73.10 |
| Shipping Dimensions (hwd / cm) | 12.70 x 16.00 x 185.67 |
| Shipping Weight (lbs.) | 13.60 |
| Shipping Weight (kg) | 6.17 |
| Unit Dimensions (hwd / in.) | 70.000 x 2.190 x 1.750 |
| Unit Dimensions (hwd / cm) | 177.8 x 5.56 x 4.45 |
| Unit Weight (lbs.) | 11.5 |
| Unit Weight (kg) | 5.22 |
| ENVIRONMENTAL | |
| Operating Temperature Range | 32° to 104°F (0° to 40°C) |



Powering Business Worldwide

| | |
|--------------------------------------|---|
| Storage Temperature Range | -22° to 140°F (-30° to 60°C) |
| Relative Humidity | 5% to 95% non-condensing |
| Operating Elevation | 0-10000 ft. (0-3000 m) |
| COMMUNICATIONS | |
| PowerAlert Software | LX Platform Interface: PowerAlert Device Manager |
| Communications Cable | RJ45-to-DB9 configuration/console Access cable |
| SNMP Compatibility | Pre-installed LX platform interface provides remote monitoring via Java-free HTML5 web interface, telnet, SSH and SNMP management systems |
| Network Compatibility | 10 Mbps; 100 Mbps (Fast Ethernet) |
| FEATURES & SPECIFICATIONS | |
| High Availability PDU Features | Remote Network Notifications |
| STANDARDS & COMPLIANCE | |
| Product Certifications | CAN/CSA-C22.2 No. 60950-1 (Canada); NOM (Mexico); UL 60950-1 |
| Product Compliance | RoHS; FCC Part 15 Class A (USA); Trade Agreements Act (TAA) |
| WARRANTY & SUPPORT | |
| Product Warranty Period (Worldwide) | 2-year limited warranty |

1000 Eaton Boulevard
Cleveland, OH 44122
United States
<https://tripplite.eaton.com>

© 2025 Eaton. All Rights Reserved.
Eaton is a registered trademark. All other trademarks
are the property of their respective owners.