

# DL-PS-60/24-JB-OD-UNI-DIM

UNIVERSAL DIMMING LED POWER SUPPLY  
24V DC HARDWIRE IN JUNCTION BOX ENCLOSURE

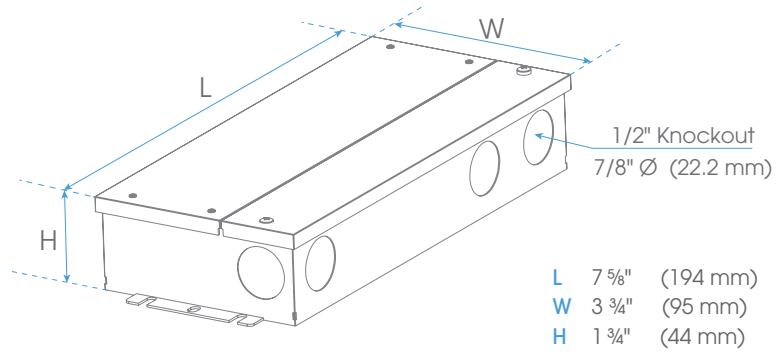

Fixture Type
Project
Notes



The DL-PS-XX/24-JB-OD-UNI-DIM series is an Outdoor Class 2 Universal Dimming 24V Power Supply with Junction Boxes for 30W, 60W, 96W, 96Wx2, 96Wx3, 96Wx4. It works with Forward phase, Reverse Phase, or 0-10V dimmers. With universal input voltage – 100 to 277V AC, it provides smooth, flicker-free PWM dimming (PWM Frequency: 800Hz). IP66, indoor/outdoor – for dry, damp, and wet locations. Cooling by free air convection. Load 10-100%, short circuit, over-temperature, and over-loading protection. Built-in PFC function, it is also UL8750 Listed and Class 2 power unit. Weights only 1.1kg (2.4lb.), includes (6) 7/8\"



**CLASS 2**  
**TYPE HL**

## SPECIFICATIONS

### INPUT

INPUT VOLTAGE	100 - 277V AC
INPUT FREQUENCY	47-63Hz
INPUT CURRENT (MAX.)	0.9A @100V AC
POWER FACTOR (TYP.) @ FULL LOAD	0.98 @ 120V AC 0.95 @ 277V AC
EFFICACY (TYP.) @ FULL LOAD	83% @ 120V AC 84% @ 277V AC
INRUSH CURRENT (TYP.)	14A, 50%, 780µs @ 120V AC 15A, 50%, 660µs @ 277V AC
THD (TYP.) @ FULL LOAD	<20%
LEAKAGE CURRENT	<0.50mA

### OUTPUT

OUTPUT VOLTAGE	24V DC
RATED OUTPUT POWER	60W
RATED LOAD CURRENT	2.50A
VOLTAGE TOLERANCE	+/-0.5V
VOLTAGE REGULATION	+/-0.5%
LOAD REGULATION	+/-1%

### PROTECTION

SHORT CIRCUIT	Shut down o/p voltage, re-power on to recover after fault condition is removed
OVER LOADING	≤120% Hiccup mode, recovers automatically after fault condition is removed
OVER TEMPERATURE	212°F+/-50°F (100°C +/-10°C) shut down o/p voltage, automatically recover after cooling

### ENVIRONMENT

IP RATINGS	IP66, Indoor/Outdoor – For Dry, Damp and Wet locations
OPERATING AMBIENT TEMPERATURE†	-40°C to +60°C (-40°F to +140°F)
OPERATING AMBIENT HUMIDITY	20~90% RH, non-condensing
STORAGE TEMPERATURE	-40°C to +80°C (-40°F to +176°F)
STORAGE HUMIDITY	10~95% RH
TEMPERATURE COEFFICIENT	+/-0.03%/°C (0~50°C)
VIBRATION	10~500Hz, 5G 10min./1 cycle period for 60min, each along X, Y and Z axes

† See Derating Curve

### SAFETY & EMC

SAFETY STANDARDS	UL8750
WITHSTAND VOLTAGE	I/P-O/P:1.88KV AC
ISOLATION RESISTANCE	I/P-O/P:100MΩ / 500V DC / 25°C / 70% RH
EMC EMISSION	FCC Part 15 B

**NY** 15 Harbor Park Drive  
Port Washington, NY 11050

**Main Fax** 800 527 7796  
855 265 5768

**CA** 219 South 6th Ave  
City of Industry, CA 91746

**Main Fax** 800 527 7796  
855 265 5768

**i** support@jescolighting.com  
**Tech Support** 855 592 0029

# DL-PS-60/24-JB-OD-UNI-DIM

UNIVERSAL DIMMING LED POWER SUPPLY  
24V DC HARDWIRE IN JUNCTION BOX ENCLOSURE



Fixture Type
Project
Notes

## WIRING DIAGRAM

### TYPICAL DIRECT WIRING: NON DIMMING APPLICATIONS

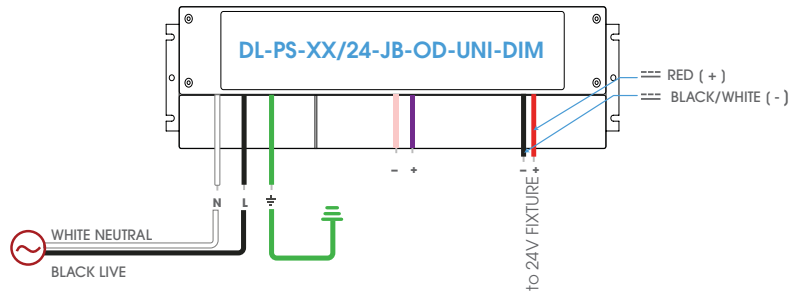

### TYPICAL DIRECT WIRING: TRIAC DIMMING

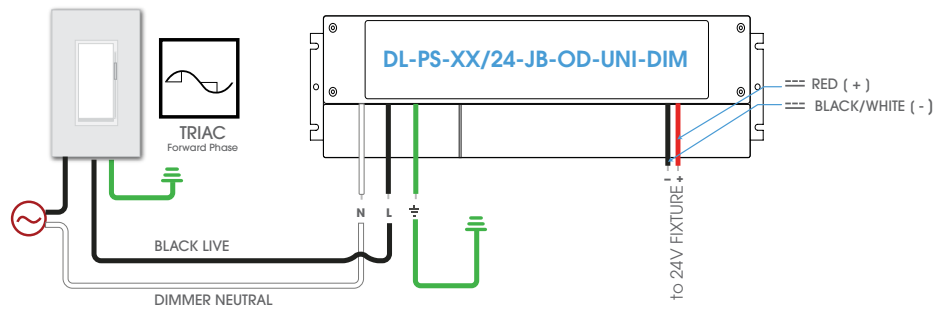

### TYPICAL DIRECT WIRING: 0 - 10 DIMMING (LOW VOLTAGE 0 - 10V DIMMER)

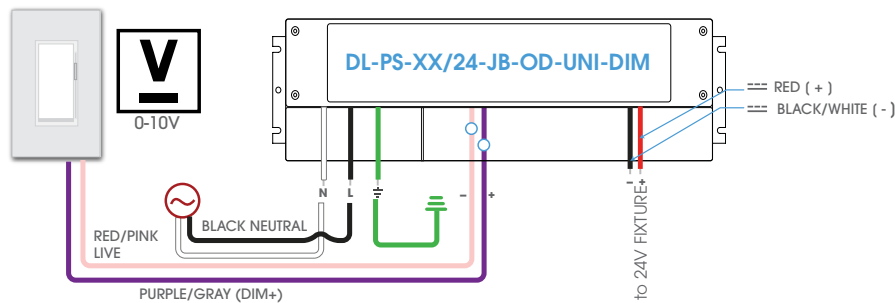

### TYPICAL DIRECT WIRING: ELV DIMMING

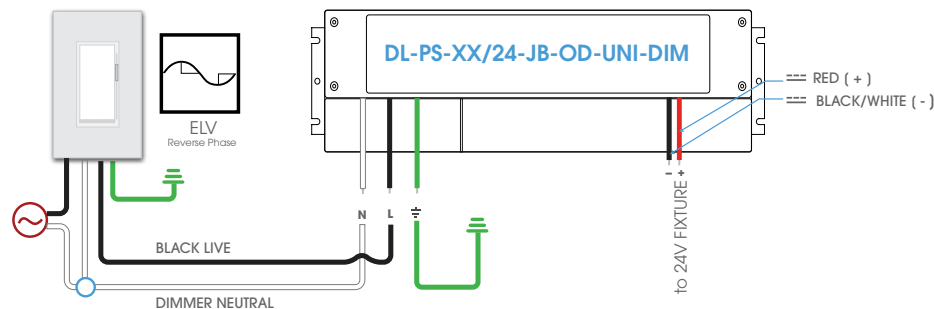

# DL-PS-60/24-JB-OD-UNI-DIM

UNIVERSAL DIMMING LED POWER SUPPLY  
24V DC HARDWIRE IN JUNCTION BOX ENCLOSURE



Fixture Type
Project
Notes

## WIRING DIAGRAM • CONNECT TO OPTIONAL EM-LIN

EMERGENCY BATTERY BACK UP ADAPTIVE CONSTANT OUTPUT POWER

For use up to **60W load** with 90 min. operational time

Any load exceeding the max EM output requires connecting dimming wires as shown in the diagrams.

### <15W ON/OFF ONLY

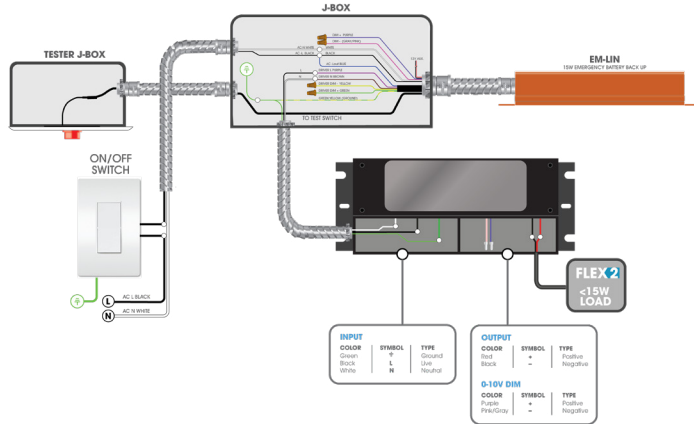

### >15W ON/OFF ONLY

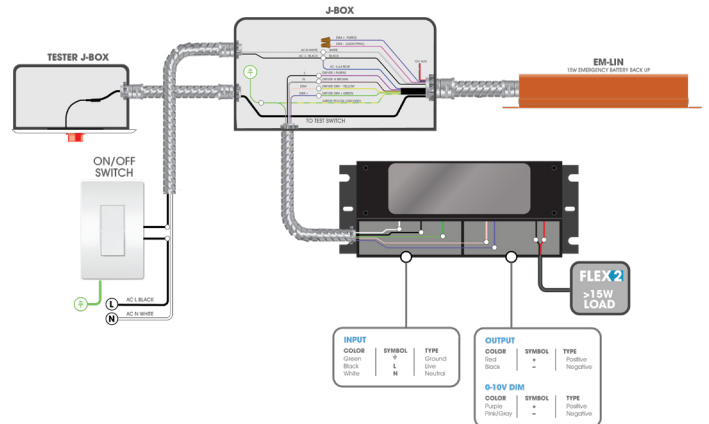

### <15W 0-10V DIMMING

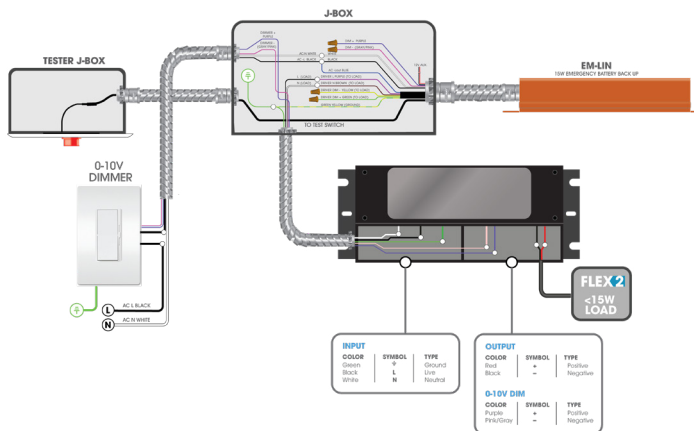

### >15W 0-10V DIMMING

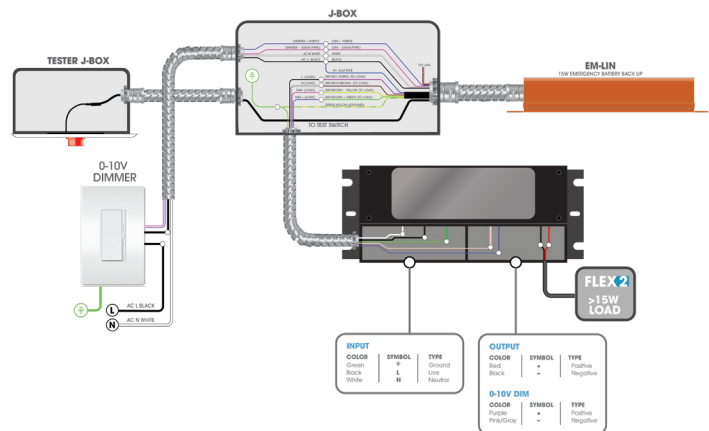

EM-LIN

# DL-PS-60/24-JB-OD-UNI-DIM

UNIVERSAL DIMMING LED POWER SUPPLY  
24V DC HARDWIRE IN JUNCTION BOX ENCLOSURE



Fixture Type
Project
Notes

## WIRING DIAGRAM • CONNECT TO OPTIONAL EM-LIN

EMERGENCY BATTERY BACK UP ADAPTIVE CONSTANT OUTPUT POWER

For use up to **96W load** with 90 min. operational time

Any load exceeding the max EM output requires connecting dimming wires as shown in the diagrams.

### <25W ON/OFF ONLY

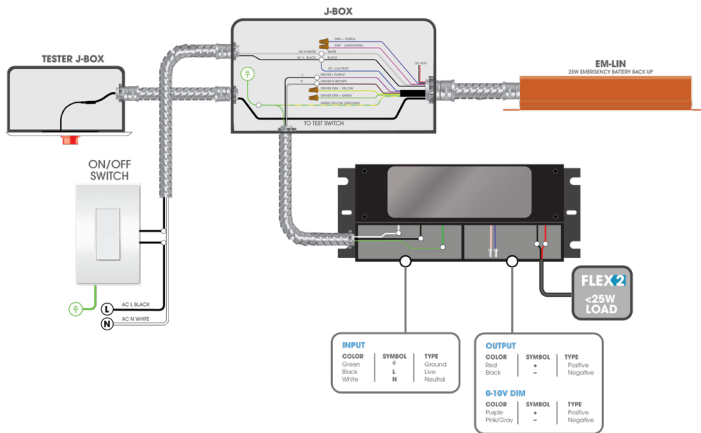

### >25W ON/OFF ONLY

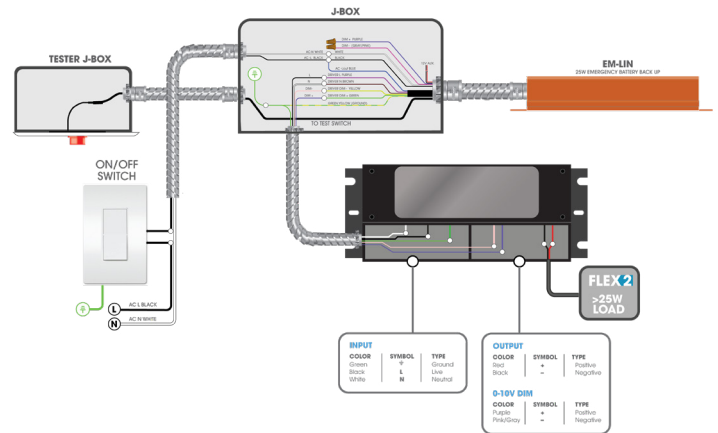

### <25W 0-10V DIMMING

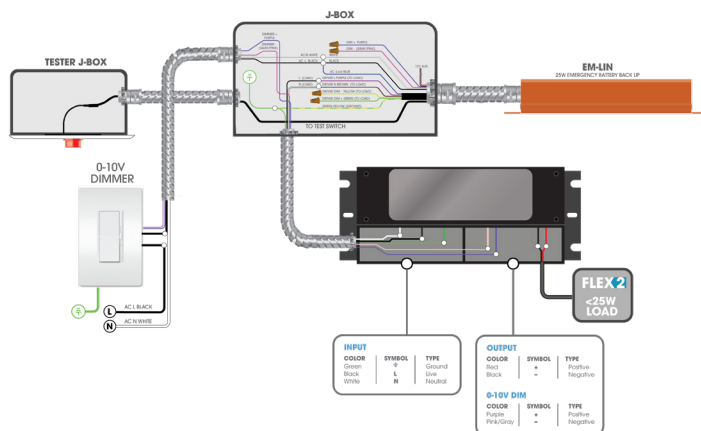

### >25W 0-10V DIMMING

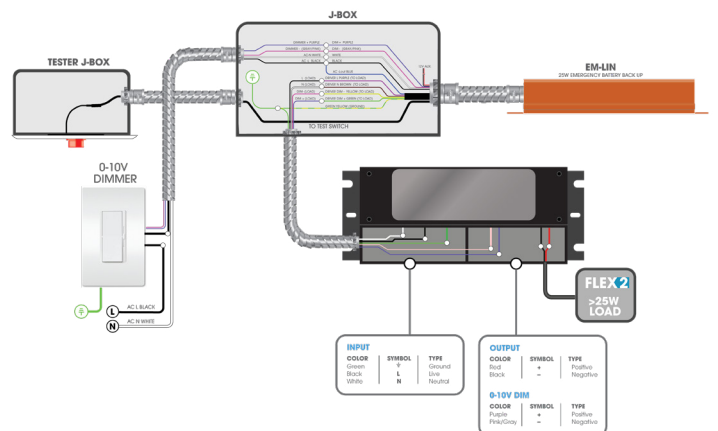

EM-LIN

# DL-PS-60/24-JB-OD-UNI-DIM

UNIVERSAL DIMMING LED POWER SUPPLY  
24V DC HARDWIRE IN JUNCTION BOX ENCLOSURE



Fixture Type
Project
Notes

## RECOMMENDED DIMMERS

BRAND	MODEL NUMBER	TYPE	INPUT VOLTAGE RANGE	DIMMING RANGE	BRAND	MODEL NUMBER	TYPE	INPUT VOLTAGE RANGE	DIMMING RANGE
LUTRON	SCL-153PR-WH	Forward Phase	100-130V	0-100%	LEVITON	VPI06-1LZ	Forward Phase	100-130V	15-100%
	DVCL-153PR-WH	Forward Phase	100-130V	0-100%		TTI06-1LZ	Forward Phase	100-130V	1-100%
	DVWCL-153PH-LA	Forward Phase	100-130V	0-100%		IPL06	Forward Phase	100-130V	15-100%
	CTCL-153PDH-LA	Forward Phase	100-130V	0-100%		DZ6HD	Forward Phase	100-130V	17-100%
	TGCL-153PR-WH	Forward Phase	100-130V	0-100%		TBL03	Forward Phase	100-130V	15-100%
	TGCL-153PH-WH	Forward Phase	100-130V	0-100%		6672	Forward Phase	100-130V	20-100%
	MACL-153MH-LA	Forward Phase	100-130V	20-100%		6602	Forward Phase	100-130V	0-100%
	CT-600PR-IV	Forward Phase	100-130V	0-100%		6674	Forward Phase	100-130V	16-100%
	CT-600PR-WH	Forward Phase	100-130V	0-100%		AWSMT-EAW	Reverse Phase	100-130V	0-100%
	CT-103PR-WH	Forward Phase	100-130V	0-100%		AWSMT-EAW	Reverse Phase	277V	0-100%
	DV-600PR-BL	Forward Phase	100-130V	0-100%		6683	Forward Phase	100-130V	10-100%
	DV-600PR-WH	Forward Phase	100-130V	0-100%					
	MIR-600M	Forward Phase	100-130V	2-100%	LEGRAND	RHCL453PNICCV6	Forward Phase	100-130V	6-100%
	TG-600PR-LA	Forward Phase	100-130V	4-100%		WSCL450TCCCV4	Forward Phase	100-130V	11-100%
	TG-600PR-IV	Forward Phase	100-130V	0-100%		LSCL453PLACCV4	Forward Phase	100-130V	11-100%
	TG-600PR-WH	Forward Phase	100-130V	0-100%					
	TG-10PR-WH	Forward Phase	100-130V	0-100%	CRESTON	CLW-DELVEX-P-W-S	Reverse Phase	100-130V	11-100%
	S-600PR-WH	Forward Phase	100-130V	0-100%					
	MRF2-6ND-120-AL	Forward Phase	100-130V	0-100%					
	MSCELV-600M	Reverse Phase	100-130V	0-100%	EATON	DF10P-C1	0-10V	120-277V	5-100%
	MEF2-6ELV-120	Reverse Phase	100-130V	0-100%					
	MRF2-6CL-GR	Forward Phase	100-130V	15-100%					
	DZ6HD	Forward Phase	100-130V	22-100%					
	PD-6WCL	Forward Phase	100-130V	19-100%					
	PD-5NE-WH	Forward Phase	100-130V	18-100%					
	NTLV-600-277-WH	Forward Phase	277V	1-100%					
	ST-12P-277	Forward Phase	277V	12-100%					
	NTF-10-277	Forward Phase	277V	1-100%					
	DVELV-300P-WH	Reverse Phase	100-130V	20-100%					
	SELV-300P	Reverse Phase	100-130V	15-100%					
	DVSTV-WH	0-10V	120-277V	9-100%					
	DVTV-WH	0-10V	120-277V	9-100%					

DERATING CURVE

TEMPERATURE (°F)	LOAD (%)
0	100
100	100
200	0

## DERATING CURVE

