

# ESENSE WALL MOUNTS

## Industrial (IP54) & In-Duct (IP50) Wall Mounts

The ESENSE-IP54 Industrial Wall Mount transmitters monitor the carbon dioxide (CO<sub>2</sub>) levels in industrial, school, and office type environments. The concentration of CO<sub>2</sub> is a good indication of the overall indoor air quality. The ESENSE Series is based on a single beam non-dispersive infrared technology and is a cost-optimized solution for the climate control of buildings and other processes. In addition, ABC software eliminates the need for manual calibration. The ESENSE Series measures the CO<sub>2</sub> concentration in the ambient air up to 2,000 ppm and converts the data into an analog output. This data can be used in conjunction with a Building

Automation or Demand Control Ventilation System to decrease energy consumption while creating a healthier indoor climate. The enclosure is IP54 rated for Industrial applications.

**Applications:** Schools, Office Buildings, Auditoriums, Gymnasiums, Shopping Malls, Theaters, Demand Control Ventilation & Economizers

**The ESENSE Room IP54 Series is covered by ACI's Five (5) Year Limited Warranty. The warranty can be found in the front of ACI's Sensors & Transmitters catalog, as well as on ACI's website, [www.workaci.com](http://www.workaci.com).**

### PRODUCT SPECIFICATIONS

<b>Supply Voltage:</b>	24 VAC/VDC $\pm 20\%$ ; 50/60Hz (Half-wave rectified)
<b>Power Consumption:</b>	<1W Average
<b>Electrical Connections:</b>	<b>Industrial:</b> 0.00232 in <sup>2</sup> (1.5 mm <sup>2</sup> ) screw terminals <b>In-Duct:</b> 13.39" (34 cm) 3-wire pigtail
<b>Operating Temperature:</b>	32°F to 122°F (0°C to 50°C)
<b>Operating RH:</b>	0 – 95% RH Non-condensing
<b>Warm-Up Time:</b>	1 minute (@ full specs 15 minutes)
<b>Accuracy<sup>1</sup>:</b>	$\pm 30$ ppm $\pm 3\%$ of reading
<b>Annual Zero Drift:</b>	$< \pm 10$ ppm
<b>Operating Pressure:</b>	+1.6% per 0.145 psi (1 kPa) deviation from normal pressure (1 Atmosphere = 14.7 psi (1.013 KPa))
<b>Sensing Method:</b>	Single beam Non-Dispersive Infrared (NDIR)
<b>Sensor Life<sup>2</sup>:</b>	>15 years
<b>Diffusion Time (T1/e):</b>	<3 minutes
<b>Operating Environment:</b>	Residential, Commercial and Industrial spaces
<b>Sensing Range:</b>	0 to 2000 ppm
<b>Extended CO<sub>2</sub> Ranges (IP54):</b>	Up to 10,000 ppm (factory set or SADK Kit required)
<b>Extended Range Accuracy:</b>	+/- 30 ppm and +/- 5% of reading
<b>Coverage Area:</b>	7500 sq. ft. maximum
<b>Mounting Height:</b>	4-6' off the floor or in duct
<b>Display (Optional):</b>	4 digits, 7 segments LCD with ppm indicator
<b>Calibration<sup>2</sup>:</b>	Senseair ABC algorithm (Automatic Baseline Correction)
<b>Outputs (Industrial):</b>	<b>Out 1:</b> 0-10V for 0-2000 ppm   <b>Out 2:</b> 2-10V or 4-20 mA for 0-2000 ppm   <b>Out 1:</b> 0-10V only (In-Duct Version)
<b>Storage:</b>	-40 to 158°F (-40 to 70°C) Non-display, -4 to 122°F (-20 to 50°C) Display
<b>Enclosure:</b>	<b>Industrial:</b> IP54 rated, Box; PC & ABS blend, Flammability Rating UL94V-0 Cover; Makrolon® 6555 plastic, Flammability Rating UL94V-0 <b>In-Duct:</b> IP50 Rated, PC & ABS blend, Flammability Rating UL94V-0
<b>Product Dimensions:</b>	<b>Industrial:</b> (H) 5.95" (151.9 mm) x (W) 3.33" (84.6 mm) x (D) 1.85" (47 mm) <b>In-Duct:</b> (H) 4.17" (106 mm) x (W) 2.64" (67 mm) x (D) 1.02" (26 mm)
<b>Agency Approvals:</b>	EMC Directive 2014/30/EC   RoHS Directive 2011/65/EU   RoHS 3 Directive 2015/863/EU

**Note 1:** Accuracy is defined after minimum three (3) ABC periods (1 period = 8 days) of continuous operations | **Note 2:** In normal Indoor Air Quality (IAQ) applications | Corrosive environments are excluded | Changes can be made using the SADK Calibration Kit and UIP5 software | **Note 3:** Building CO<sub>2</sub> levels must drop to 400 ppm some time during the week for ABC to work properly. If the building is occupied 24 hrs/day, ABC must be turned off





## DIMENSIONAL DRAWING

### In Duct Wall Mount

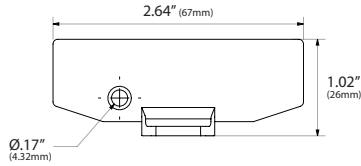
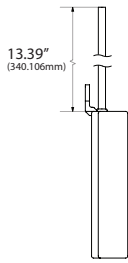
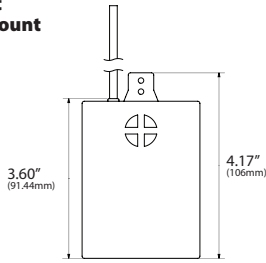

### Industrial Wall Mount

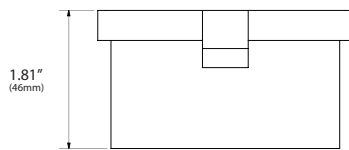
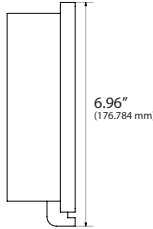
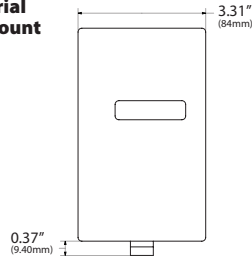

Front View

Right View

Top View

## STANDARD ORDERING

Model # Example: ESENSE-IP54 -OR- 130168

Model #	Item #	Description
ESENSE-IP54-LCD	130169	CO2 Industrial Wall Mount with Display, 0-10 VDC or 4-20 mA Output
ESENSE-IP50	130030	CO2 Industrial In Duct / Wall Mount, 0-10 VDC Output

## ACCESSORIES ORDERING

Model # Example: A/CUSTOM CAL GAS -OR- 140970

Model #	Item #	Description
A/CUSTOM CAL GAS*	140970	Custom Calibration (IP54 only)
SADK	130502	SADK Calibration Kit
UIP5	----	Free Software Download (Contact ACI)

**Note\*:** Contact ACI's Technical Support for custom calibration ranges

