

PART NO.

RFDC-8DBC-43F

REV	DESCRIPTION	DWN	DATE	APPROVED
A	UPDATED MOUNTING DESIGN AND DIMENSION THROUGHOUT	CZS	08/08/19	JDMc

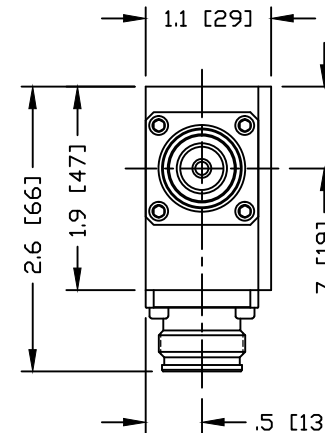
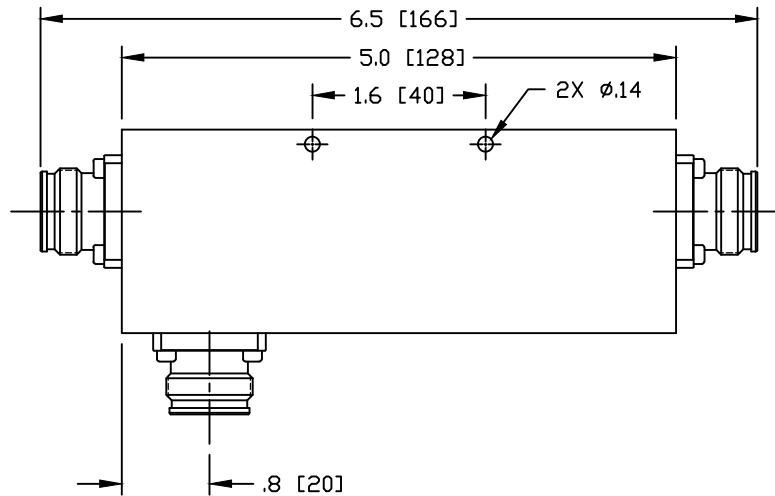

SPECIFICATIONS:

IMPEDANCE: 50 Ohms
 OPERATION FREQUENCY BAND: 698–2700 MHz
 COUPLING: –8dB
 COUPLING TOLERANCE: ± 0.8 dB
 INSERTION LOSS: ≤ 1.30 dB
 ISOLATION: ≥ 28 dB
 VSWR: ≤ 1.25
 3RD INTERMODULATION: ≤ -155 dBc (RELATIVE TO CARRIER)
 3RD INTERMODULATION TEST METHOD: 2x43dBm CARRIERS
 AVERAGE POWER: 300 WATT
 INNER CONTACT PLATING: SILVER
 OUTER PLATING: WHITE BRONZE
 OPERATION TEMPERATURE: $-35^{\circ}\text{C} \sim +65^{\circ}\text{C}$
 APPLICATION: INDOOR/OUTDOOR
 REGULATORY COMPLIANCE/CERTIFICATIONS: RoHS/IP65

CUSTOMER
OUTLINE DRAWINGALL DIMENSIONS
ARE REFERENCE ONLY
 UNLESS OTHERWISE SPECIFIED:
 DIMENSIONS ARE IN INCHES
 AND [MILLIMETERS]

DRAWN	
C. ZUNIGA	08/08/19
CHECKED	
ORJ DRAWN	
C. ZUNIGA	06/06/16

RoHS
COMPLIANT

 PROPRIETARY AND CONFIDENTIAL
 THIS DRAWING CONTAINS
 INFORMATION PROPRIETARY TO
 RF INDUSTRIES. ANY
 UNAUTHORIZED USE OF THIS
 DRAWING IS EXPRESSLY
 PROHIBITED WITHOUT WRITTEN
 PERMISSION FROM RF
 INDUSTRIES. ANY VIOLATION IS
 PUNISHABLE UNDER U.S.
 COPYRIGHT LAWS.

RFconnectors
 DIVISION OF RF INDUSTRIES, LTD.

 7610 MIRAMAR RD.
 SAN DIEGO, CA 92126
 (858) 549-6340
 (858) 549-6345 FAX

8 dB DIRECTIONAL COUPLER
4.3-10 FEMALE - 698-2700 MHz

SIZE	CABLE GROUP	DWG NO.	REVISION
A		RFDC-8DBC-43F	A
SCALE:	ENGINEERING ID:	SHEET 1 OF 1	
NTS	000000		