



QMA Female Right Angle Connector Solder Attachment Surface Mount PCB

TECHNICAL DATA SHEET

PE44511

QMA Female Right Angle Connector Solder Attachment Surface Mount PCB

Configuration

| | |
|--|---------------|
| Connector | QMA Female |
| Connector Interface Type | Surface Mount |
| Cable Attachment Method (Shield/Contact) | Solder |
| Body Style | Right Angle |

Electrical Specifications

| | |
|-----------------|----|
| Impedance, Ohms | 50 |
|-----------------|----|

Mechanical Specifications

Size

| | |
|---------------------|---------------|
| Length, in [mm] | 0.953 [24.21] |
| Width/Dia., in [mm] | 0.531 [13.49] |
| Height, in [mm] | 0.394 [10.01] |
| Weight, lbs [g] | 0.006 [2.72] |

Connector

| | |
|------------------------------|-------------|
| Type | QMA Female |
| Contact Material and Plating | Gold |
| Body Material and Plating | Brass, Gold |
| Dielectric Type | PTFE |

Compliance Certifications (visit www.Pasternack.com for current document)

| | |
|----------------|-----|
| RoHS Compliant | Yes |
|----------------|-----|

Plotted and Other Data

| | |
|--------|----------------------------|
| Notes: | Values at 25 °C, sea level |
|--------|----------------------------|

QMA Female Right Angle Connector Solder Attachment Surface Mount PCB from Pasternack Enterprises has same day shipment for domestic and International orders. Our RF, microwave and fiber optic products maintain a 99% availability and are part of the broadest selection in the industry.

Click the following link (or enter part number in "SEARCH" on website) to obtain additional part information including price, inventory and certifications: [QMA Female Right Angle Connector Solder Attachment Surface Mount PCB PE44511](http://www.pasternack.com/qma-female-right-angle-connector-solder-attachment-surface-mount-pcb-pe44511)

URL: <http://www.pasternack.com/qma-female-standard-surface-mount-pcb-connector-pe44511-p.aspx>

The information contained in this document is accurate to the best of our knowledge and representative of the part described herein. It may be necessary to make modifications to the part and/or the documentation of the part, in order to implement improvements. Pasternack reserves the right to make such changes as required. Unless otherwise stated, all specifications are nominal.

QMA Female Right Angle Connector Solder Attachment Surface Mount PCB

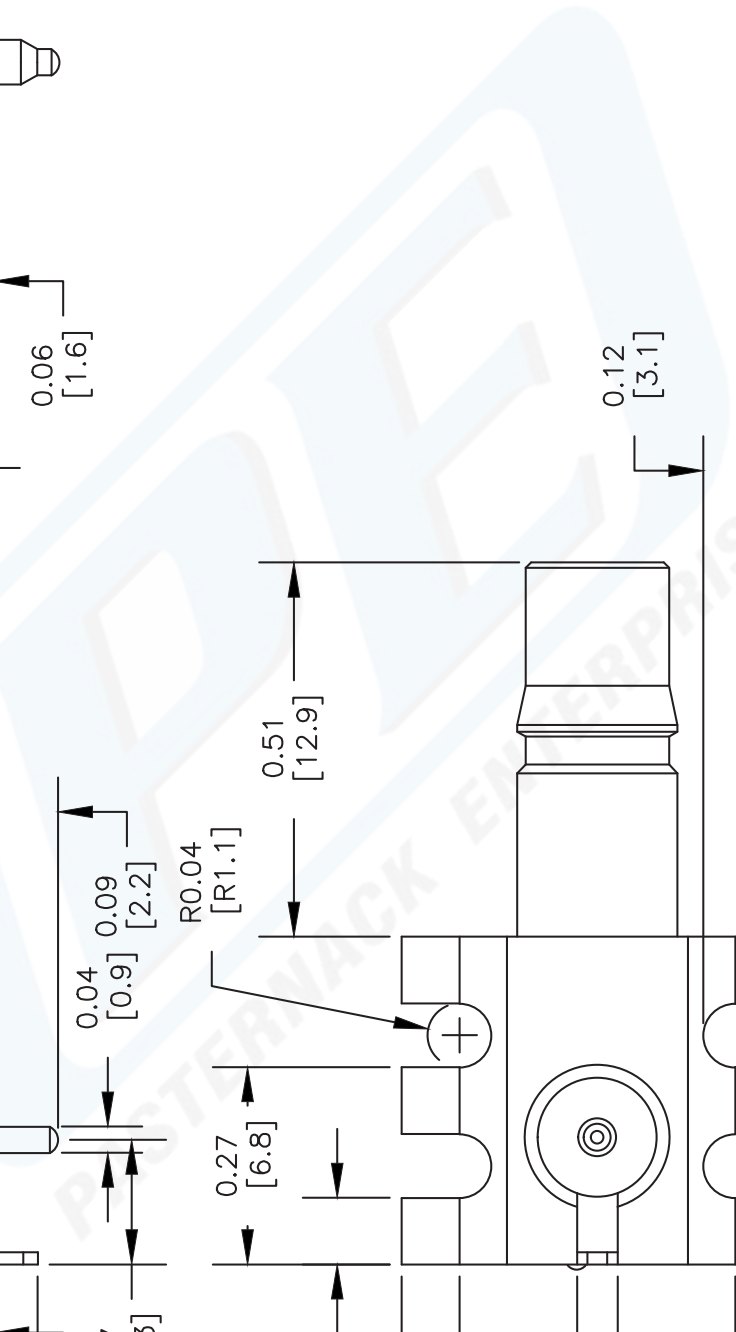

PE44511

PE PASTERNAK®
Pasternack Enterprises, Inc.
P.O. Box 16759 | Irvine | CA | 92623
Phone: (949) 261-1920 | **Fax:** (949) 261-7451
Website: www.pasternack.com | **E-Mail:** sales@pasternack.com

127