

## Medium Power 50 Watts RF Load Up To 4 GHz With 7/16 DIN Male Input Square Body Black Anodized Aluminum Heatsink



### PE6169

#### Features

#### Applications

#### Description

#### Electrical Specifications

Description	Minimum	Typical	Maximum	Units
Frequency Range	DC		4	GHz
Impedance		50		Ohms
VSWR, Input			1.25:1	
Input Power (CW)			50	Watts
Input Power (Peak)			5	kWatts

#### Performance by Frequency

Description	F1	F2	F3	F4	F5	Units
Frequency Range	DC to 2	2 to 4				GHz
VSWR, Input Max	1.15:1	1.25:1				

#### Mechanical Specifications

##### Size

Length	5.15 in [130.81 mm]
Width	2.765 in [70.23 mm]
Height	3.5 in [88.9 mm]
Weight	2.1 lbs [952.54 g]

##### Configuration

Connector	7/16 DIN Male
-----------	---------------

#### Material Specifications

Description	Material	Plating
Connector 1 Contact		Gold
Insulation	PTFE	
Connector 1 Body	Brass	Nickel
Coupling Nut	Brass	Nickel
Housing	Black Anodized Aluminum Heatsink	

## Medium Power 50 Watts RF Load Up To 4 GHz With 7/16 DIN Male Input Square Body Black Anodized Aluminum Heatsink



### PE6169

#### Environmental Specifications

##### Temperature

**Compliance Certifications** (see [product page](#) for current document)

#### Plotted and Other Data

##### Notes:

Medium Power 50 Watts RF Load Up To 4 GHz With 7/16 DIN Male Input Square Body Black Anodized Aluminum Heatsink from Pasternack Enterprises has same day shipment for domestic and International orders. Our RF, microwave and millimeter wave products maintain a 99.4% availability and are part of the broadest selection in the industry.

Click the following link (or enter part number in "SEARCH" on website) to obtain additional part information including price, inventory and certifications: [Medium Power 50 Watts RF Load Up To 4 GHz With 7/16 DIN Male Input Square Body Black Anodized Aluminum Heatsink PE6169](#)

URL: <https://www.pasternack.com/50-watts-7-16-male-rf-load-up-to-4-ghz-pe6169-p.aspx>

The information contained within this document is accurate to the best of our knowledge and representative of the part described herein. It may be necessary to make modifications to the part and/or the documentation of the part in order to implement improvements. Pasternack Enterprises reserves the right to make such changes as required. Unless otherwise stated, all specifications are nominal. Pasternack Enterprises does not make any representation or warranty regarding the suitability of the part described herein for any particular purpose, and Pasternack Enterprises does not assume liability arising out of the use of any part or document.

PE6169 CAD Drawing

Medium Power 50 Watts RF Load Up To 4 GHz With 7/16 DIN Male Input

Square Body Black Anodized Aluminum Heatsink

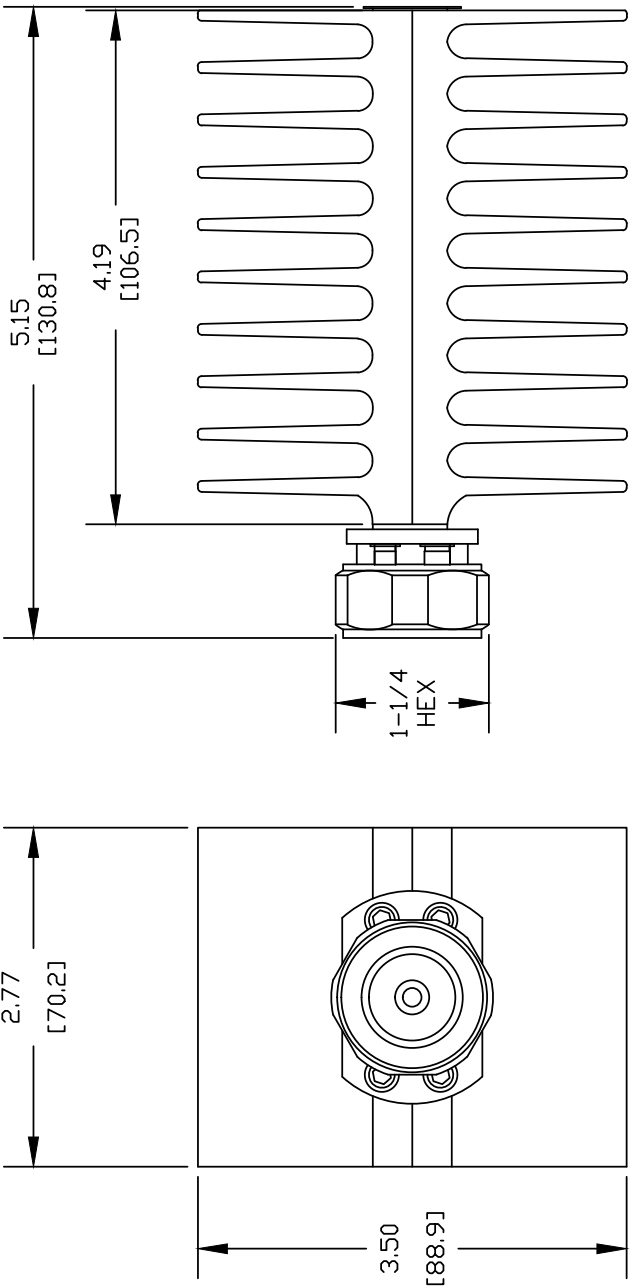

NOTES:  
1. UNLESS OTHERWISE SPECIFIED ALL DIMENSIONS ARE NOMINAL.  
2. ALL SPECIFICATIONS ARE SUBJECT TO CHANGE WITHOUT NOTICE AT ANY TIME.  
3. DIMENSIONS ARE IN INCHES (mm).

DWG TITLE  
**PE6169**

FSCM NO. 53919

CAD FILE 020909-A

SCALE N/A

SIZE A

XXXX

**PE PASTERNAK®**  
Pasternack Enterprises, Inc.  
P.O. Box 16759 | Irvine | CA | 92623  
Phone: (949) 261-1920 | Fax: (949) 261-7451  
Website: [www.pasternack.com](http://www.pasternack.com) | E-Mail: [sales@pasternack.com](mailto:sales@pasternack.com)