



## 1 Watt RF Load Up to 4 GHz with SMB Jack

### RF Terminations Technical Data Sheet

PE6TR002

#### Electrical Specifications

Description	Minimum	Typical	Maximum	Units
Frequency Range	DC		4	GHz
Impedance		50		Ohms
VSWR			1.2:1	
Return Loss			20	dB
Input Power (CW)			1	Watts
Input Power (Peak)			1	KWatts

#### Mechanical Specifications

<b>Size</b>	
Length	0.591 in [15.01 mm]
Width	0.276 in [7.01 mm]
Weight	0.005 lbs [2.27 g]

<b>Configuration</b>	
Connector	SMB Jack

#### Material Specifications

Description	Material	Plating
Body	Brass	Gold

#### Environmental Specifications

<b>Temperature</b>	
Operating Range	-55 to +125 deg C

#### Compliance Certifications (see [product page](#) for current document)

#### Plotted and Other Data

Notes:

Click the following link (or enter part number in "SEARCH" on website) to obtain additional part information including price, inventory and certifications: [1 Watt RF Load Up to 4 GHz with SMB Jack PE6TR002](#)



## 1 Watt RF Load Up to 4 GHz with SMB Jack

### RF Terminations Technical Data Sheet

PE6TR002

1 Watt RF Load Up to 4 GHz with SMB Jack from Pasternack Enterprises has same day shipment for domestic and International orders. Our RF, microwave and millimeter wave products maintain a 99% availability and are part of the broadest selection in the industry.

Click the following link (or enter part number in "SEARCH" on website) to obtain additional part information including price, inventory and certifications: [1 Watt RF Load Up to 4 GHz with SMB Jack PE6TR002](https://www.pasternack.com/1-watts-smb-jack-rf-load-4-ghz-pe6tr002-p.aspx)

URL: <https://www.pasternack.com/1-watts-smb-jack-rf-load-4-ghz-pe6tr002-p.aspx>

The information contained in this document is accurate to the best of our knowledge and representative of the part described herein. It may be necessary to make modifications to the part and/or the documentation of the part, in order to implement improvements. Pasternack reserves the right to make such changes as required. Unless otherwise stated, all specifications are nominal. Pasternack does not make any representation or warranty regarding the suitability of the part described herein for any particular purpose, and Pasternack does not assume any liability arising out of the use of any part or documentation.

# PE6TR002 CAD Drawing

1 Watt RF Load Up to 4 GHz with SMB Jack

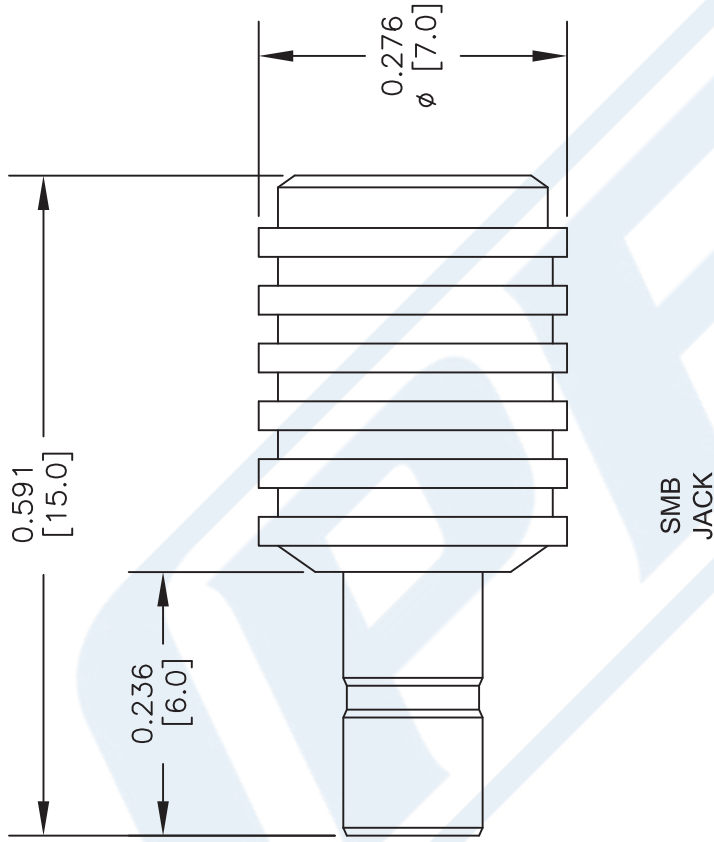

## STANDARD TOLERANCES

.X ±0.2  
.XX ±0.1  
.XXX ±0.05

\*STANDARD TOLERANCES APPLY  
ONLY TO DIMENSIONS IN INCHES



THE ENGINEER'S RF SOURCE

Pasternack Enterprises, Inc.

P.O. Box 16759 | Irvine | CA | 92623

Phone: (949) 261-1920 | Fax: (949) 261-7451

Website: [www.pasternack.com](http://www.pasternack.com) | E-Mail: [sales@pasternack.com](mailto:sales@pasternack.com)

DWG TITLE

**PE6TR002**

NOTES:

1. UNLESS OTHERWISE SPECIFIED ALL DIMENSIONS ARE NOMINAL.
2. ALL SPECIFICATIONS ARE SUBJECT TO CHANGE WITHOUT NOTICE AT ANY TIME.
3. DIMENSIONS ARE IN INCHES [mm].

CAGE CODE 53919

CAD FILE 103116

SCALE N/A

SIZE A

2233