

15KEBS6AFPD

✓ ACTIVE

Corcom KEB

TE Internal #: 1-1609965-4

15 A 3-Phase Filter, Threaded Bolt Input, Threaded Bolt Output, DELTA (3 wire + ground), 440 VAC, Chassis Mount, Corcom KEB

[View on TE.com >](#)



EMI & EMC Solutions > EMI Filters > Power Line Filters > 3-Phase Filters

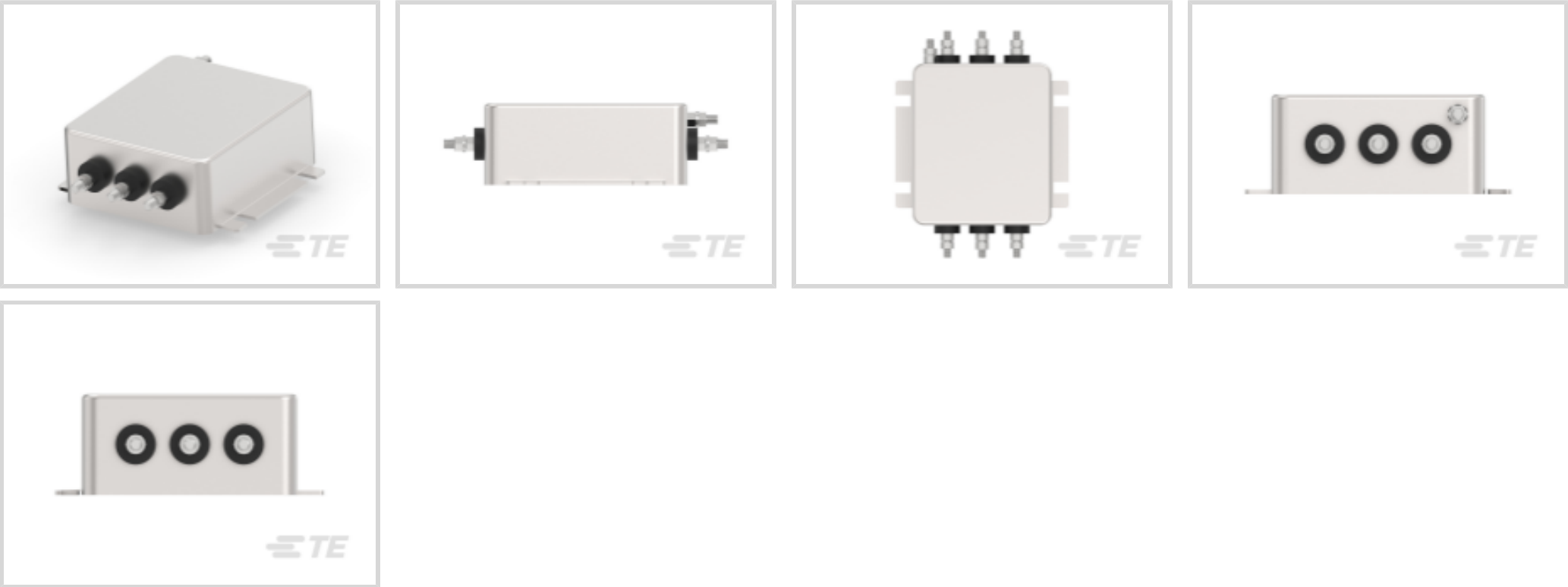

Current Rating: 15 A

Input Termination Type: Threaded Bolt

Output Termination Type: Threaded Bolt

Wiring Configuration: DELTA (3 wire + ground)

Operating Voltage: 440 VAC

Features

Product Type Features

Filtering Requirements	Filtered
Input Termination Type	Threaded Bolt
Output Termination Type	Threaded Bolt

Configuration Features

Wiring Configuration	DELTA (3 wire + ground)
----------------------	-------------------------

Electrical Characteristics

Leakage Current (Max) (230VAC, 50Hz)	3
Current Rating	15 A
Operating Voltage	440 VAC

Mechanical Attachment

Product Mount Type	Chassis Mount
--------------------	---------------

Usage Conditions

Operating Temperature Range	-25 – 85 °C
-----------------------------	-------------



Product Compliance

For compliance documentation, visit the product page on TE.com>

EU RoHS Directive 2011/65/EU	Compliant
EU ELV Directive 2000/53/EC	Compliant
China RoHS 2 Directive MIIT Order No 32, 2016	No Restricted Materials Above Threshold
EU REACH Regulation (EC) No. 1907/2006	Current ECHA Candidate List: JAN 2025 (247) Candidate List Declared Against: JUNE 2023 (235) Does not contain REACH SVHC
Halogen Content	Low Halogen - Br, Cl, F, I < 900 ppm per homogenous material. Also BFR/CFR/PVC Free
Solder Process Capability	Not reviewed for solder process capability

Product Compliance Disclaimer

This information is provided based on reasonable inquiry of our suppliers and represents our current actual knowledge based on the information they provided. This information is subject to change. The part numbers that TE has identified as EU RoHS compliant have a maximum concentration of 0.1% by weight in homogenous materials for lead, hexavalent chromium, mercury, PBB, PBDE, DBP, BBP, DEHP, DIBP, and 0.01% for cadmium, or qualify for an exemption to these limits as defined in the Annexes of Directive 2011/65/EU (RoHS2). Finished electrical and electronic equipment products will be CE marked as required by Directive 2011/65/EU. Components may not be CE marked. Additionally, the part numbers that TE has identified as EU ELV compliant have a maximum concentration of 0.1% by weight in homogenous materials for lead, hexavalent chromium, and mercury, and 0.01% for cadmium, or qualify for an exemption to these limits as defined in the Annexes of Directive 2000/53/EC (ELV). Regarding the REACH Regulation, the information TE provides on SVHC in articles for this part number is based on the latest European Chemicals Agency (ECHA) ‘Guidance on requirements for substances in articles’ posted at this URL: <https://echa.europa.eu/guidance-documents/guidance-on-reach>

Compatible Parts



Also in the Series | Corcom KEB



3-Phase Filters(38)

Customers Also Bought

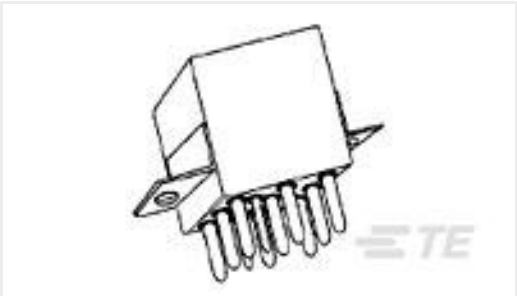

TE Part #5-1617753-0
FCA-325-BZ4

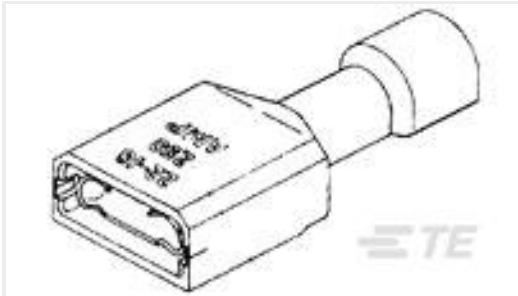

TE Part #2-520272-2
ULTRA-FAST .110/.125 ASY REC 22-18 TPBR

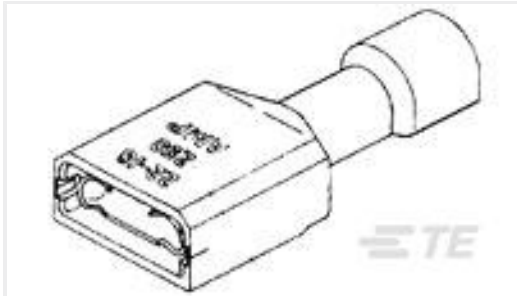

TE Part #9-520272-2
ULTRA-FAST .110/.125 ASY REC 22-18 TPBR



TE Part #1735801-1
2.0mm,Crimp,Contact

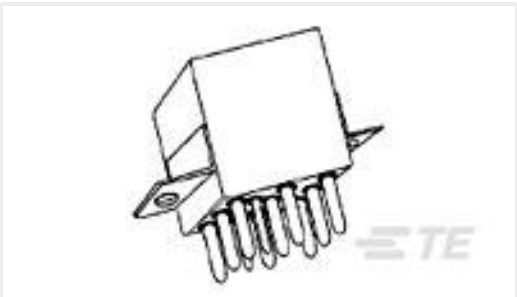

TE Part #3-1617753-9
FCA-325-AY4

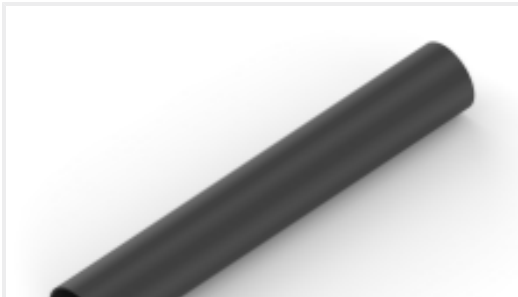

TE Part #NB09542001
ATUM-16/4-0-STK



TE Part #1827587-2
DYNAMIC D1000 REC CONT M AU 0.38um L/P



TE Part #320559
PIDG SPLICE 22-16COMM 22-18MIL



TE Part #323672
SPLICE,SOLIS PARA HT 12-10

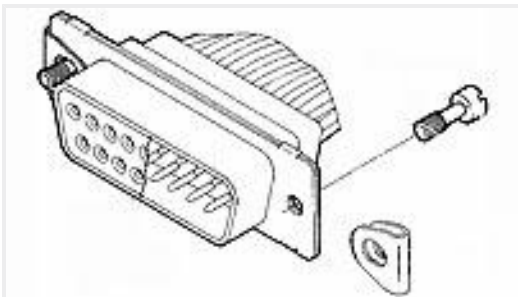

TE Part #211883-5
SCREW RETAINER KIT,AMPLIMITE

Documents

Product Drawings

KEB 15A 1S NUT DELTA 440VAC

English

CAD Files

Customer View Model

ENG_CVM_CVM_1-1609965-4_B.3d_igs.zip

English

Customer View Model

15KEBS6AFPD

15 A 3-Phase Filter, Threaded Bolt Input, Threaded Bolt Output, DELTA (3 wire + ground), 440 VAC, Chassis Mount, Corcom KEB



[ENG_CVM_CVM_1-1609965-4_B.3d_stp.zip](#)

English

Customer View Model

[ENG_CVM_CVM_1-1609965-4_B.2d_dxf.zip](#)

English

3D PDF

3D

By downloading the CAD file I accept and agree to the [Terms and Conditions](#) of use.

Datasheets & Catalog Pages

KEB SERIES

English