

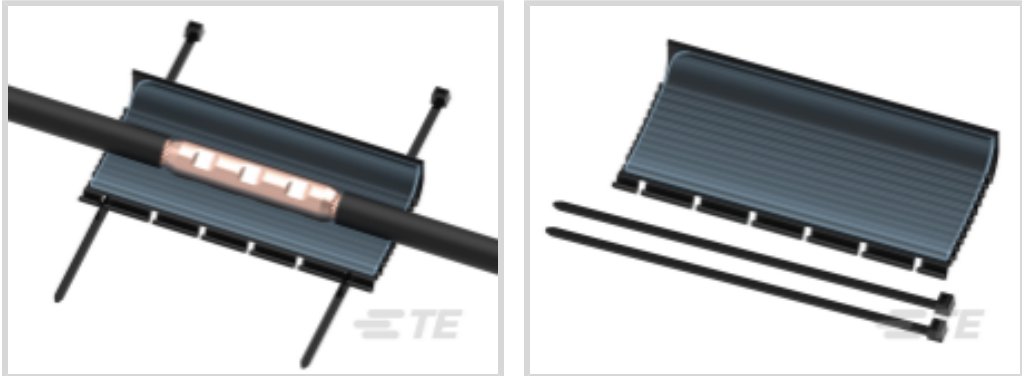

Energy & Power > Power Cable Accessories > Joints & Splices



Installation Technology: **Power Gel**

Product Availability: **Europe, Middle East & Africa**

Joints & Splice Product Type: **Splice Closure**

Voltage Class: **≤ 1 kV**

Compatible Conductor Range: **250 – 750 AWG/kcmil**

Features

Product Type Features

Case Seal	Gel
Cable Sealing Method	Gel
Adhesive Coating	With
Filler	PowerGel
Installation Technology	Power Gel
Joints & Splice Product Type	Splice Closure
Closing Method	Snap

Configuration Features

Number of Main Wires (Max)	1
----------------------------	---

Electrical Characteristics

Voltage Class	≤ 1 kV
---------------	--------

Body Features

Primary Product Color	Black
Flexibility	Semi-Flexible

Mechanical Attachment

Mechanical Reinforcement	Cable Ties
Strain Relief	Without



Dimensions

Compatible Cable Diameter - Main (Min)	20 mm
Compatible Conductor Range	250 – 750 AWG/kcmil
Compatible Insulation Diameter Range	20 – 38 mm[.8 – 1.5 in]
Compatible Cable Cross-Section - Main (Max)	500 mm²
Compatible Cable Cross-Section - Main (Min)	150 mm²
Compatible Cable Diameter - Main (Max)	50 mm
Compatible Conductor Diameter Range	.8 – 1.5 mm[20 – 50 in]

Usage Conditions

Operating Temperature Range	-40 – 95 °C
Fluid Resistance Type	Humic Acids, Hydrochloric Acid, Motor Oil, Sodium Chloride, Sodium Hydroxide, Water
Environmental Resistance	Moisture, Protection Against Humidity, Rain, Self Sealing, Water Repelant, Weathering

Operation/Application

Mechanical Resistance	Against Mechanical Impact
UV-Stabilized	Yes
Marine-Offshore-Shipbuilding Certified	No

Industry Standards

Compatible With Approved Standards Products	ANSI C119.1, EN 50393
---	-----------------------

Product Availability

Product Availability	Europe, Middle East & Africa
----------------------	------------------------------

Packaging Features

Packaging Method	Bag
Packaging Quantity	1

Other

Product Use	Outdoor, Overhead & Direct Buried
-------------	-----------------------------------

Product Compliance

For compliance documentation, visit the product page on [TE.com](#)>

EU RoHS Directive 2011/65/EU	Compliant
EU ELV Directive 2000/53/EC	Compliant



China RoHS 2 Directive MIIT Order No 32, 2016	No Restricted Materials Above Threshold
EU REACH Regulation (EC) No. 1907/2006	Current ECHA Candidate List: JAN 2025 (247) Candidate List Declared Against: JAN 2024 (240) Does not contain REACH SVHC
Halogen Content	Low Halogen - Br, Cl, F, I < 900 ppm per homogenous material. Also BFR/CFR/PVC Free
Solder Process Capability	Not applicable for solder process capability

Product Compliance Disclaimer

This information is provided based on reasonable inquiry of our suppliers and represents our current actual knowledge based on the information they provided. This information is subject to change. The part numbers that TE has identified as EU RoHS compliant have a maximum concentration of 0.1% by weight in homogenous materials for lead, hexavalent chromium, mercury, PBB, PBDE, DBP, BBP, DEHP, DIBP, and 0.01% for cadmium, or qualify for an exemption to these limits as defined in the Annexes of Directive 2011/65/EU (RoHS2). Finished electrical and electronic equipment products will be CE marked as required by Directive 2011/65/EU. Components may not be CE marked. Additionally, the part numbers that TE has identified as EU ELV compliant have a maximum concentration of 0.1% by weight in homogenous materials for lead, hexavalent chromium, and mercury, and 0.01% for cadmium, or qualify for an exemption to these limits as defined in the Annexes of Directive 2000/53/EC (ELV). Regarding the REACH Regulation, the information TE provides on SVHC in articles for this part number is based on the latest European Chemicals Agency (ECHA) 'Guidance on requirements for substances in articles' posted at this URL: <https://echa.europa.eu/guidance-documents/guidance-on-reach>

Compatible Parts

TE Part # A97829-000  
GELWRAP-50/20-400(B12)

TE Part # 709794-000  
GELWRAP-50/20-200(B12)

TE Part # F24535-000  
GELWRAP-UF-200(B10)

TE Part # C76897-000  
GELWRAP-50/20-350(B12)

TE Part # D61559-000  
GELWRAP-50/20-250(B12)

Also in the Series | RAYCHEM GelWrap



Joints & Splices(24)

Customers Also Bought



TE Part #E13495-000  
GELWRAP-33/10-150(B6)

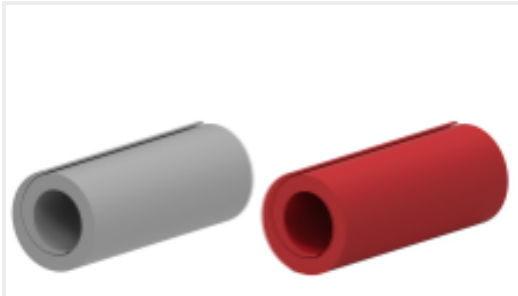

TE Part #BM7955-000  
MVCC-G-19/.75(S15)



TE Part #733882-000  
BAH-023000048



TE Part #CZ4070-000  
CSTO-3131-GB01

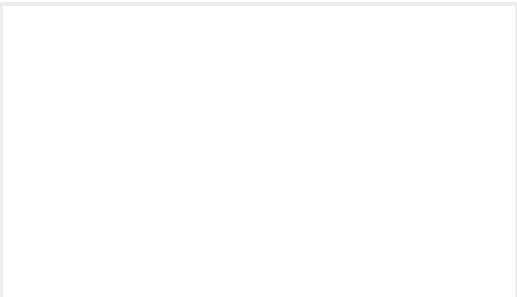

TE Part #CN3758-000  
GELBOX-25-GB01



TE Part #CP9378-000  
BCIC-1217-PE(B15)

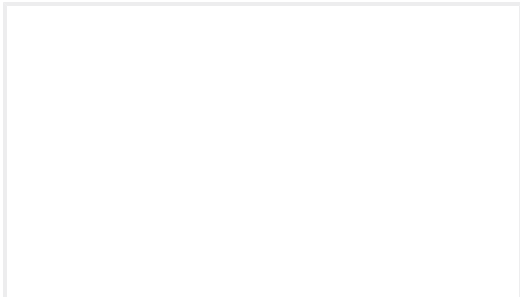

TE Part #D80933-512  
BAH-024030129

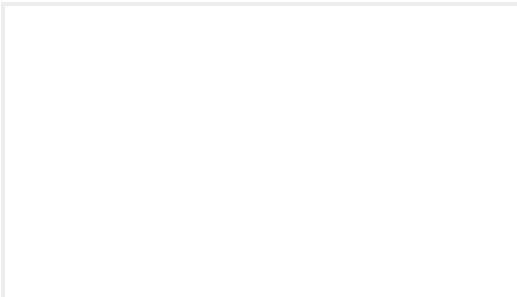

TE Part #EN7076-000  
SMOE-64303

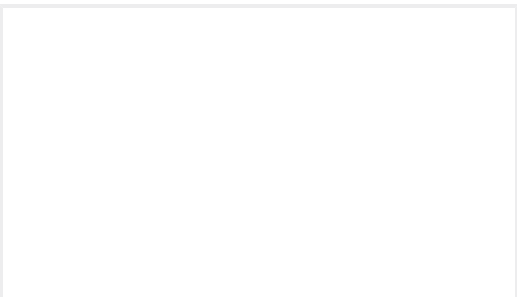

TE Part #2099695-2  
HEL-5028

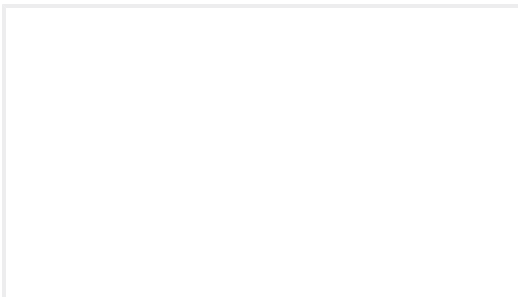

TE Part #EN1873-000  
MM-7-GC520-6877.1-DE01

Documents

Product Drawings

GELWRAP-50/20-300(B12)

English

Datasheets & Catalog Pages

GELWRAP-WRAPAROUND-SLEEVE-CABLE-ACCESSORIES

English