

3KEBS1BFPD

✓ ACTIVE

Corcom KEB

TE Internal #: 4-1609965-1

3 A 3-Phase Filter, FASTON Input, .250" FASTON Output, DELTA (3 wire + ground), 520 VAC, Chassis Mount, Corcom KEB

[View on TE.com >](#)



EMI & EMC Solutions > EMI Filters > Power Line Filters > 3-Phase Filters



Current Rating: 3 A

Input Termination Type: FASTON

Output Termination Type: .250" FASTON

Wiring Configuration: DELTA (3 wire + ground)

Operating Voltage: 520 VAC

Features

Product Type Features

Filtering Requirements	Filtered
Input Termination Type	FASTON
Output Termination Type	.250" FASTON

Configuration Features

Wiring Configuration	DELTA (3 wire + ground)
----------------------	-------------------------

Electrical Characteristics

Leakage Current (Max) (230VAC, 50Hz)	3
Current Rating	3 A
Operating Voltage	520 VAC

Mechanical Attachment

Product Mount Type	Chassis Mount
--------------------	---------------

Usage Conditions

Operating Temperature Range	-25 – 85 °C
-----------------------------	-------------



Product Compliance

For compliance documentation, visit the product page on TE.com>

EU RoHS Directive 2011/65/EU	Compliant
EU ELV Directive 2000/53/EC	Compliant
China RoHS 2 Directive MIIT Order No 32, 2016	No Restricted Materials Above Threshold
EU REACH Regulation (EC) No. 1907/2006	Current ECHA Candidate List: JAN 2025 (247) Candidate List Declared Against: JUNE 2024 (241) Does not contain REACH SVHC
Halogen Content	Not Low Halogen - contains Br or Cl > 900 ppm.
Solder Process Capability	Not reviewed for solder process capability

Product Compliance Disclaimer

This information is provided based on reasonable inquiry of our suppliers and represents our current actual knowledge based on the information they provided. This information is subject to change. The part numbers that TE has identified as EU RoHS compliant have a maximum concentration of 0.1% by weight in homogenous materials for lead, hexavalent chromium, mercury, PBB, PBDE, DBP, BBP, DEHP, DIBP, and 0.01% for cadmium, or qualify for an exemption to these limits as defined in the Annexes of Directive 2011/65/EU (RoHS2). Finished electrical and electronic equipment products will be CE marked as required by Directive 2011/65/EU. Components may not be CE marked. Additionally, the part numbers that TE has identified as EU ELV compliant have a maximum concentration of 0.1% by weight in homogenous materials for lead, hexavalent chromium, and mercury, and 0.01% for cadmium, or qualify for an exemption to these limits as defined in the Annexes of Directive 2000/53/EC (ELV). Regarding the REACH Regulation, the information TE provides on SVHC in articles for this part number is based on the latest European Chemicals Agency (ECHA) 'Guidance on requirements for substances in articles' posted at this URL: <https://echa.europa.eu/guidance-documents/guidance-on-reach>

Compatible Parts



Also in the Series | Corcom KEB

3KEBS1BFPD

3 A 3-Phase Filter, FASTON Input, .250" FASTON Output, DELTA (3 wire + ground), 520 VAC, Chassis Mount, Corcom KEB



3-Phase Filters(38)

Customers Also Bought



TE Part #6609042-4  
20VS1=F7249 S0



TE Part #364240-E  
SRCBUG A 2,54 2 6 CSI 112 E1 ADV J 2 324



TE Part #1SNK705012R0000  
ZK2.5-4P



TE Part #T4033014041-000  
M8.FMLE.PNLFRONT.4POS.STR

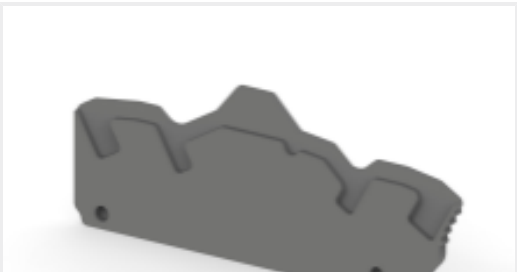

TE Part #1SNK705912R0000  
EK2.5-4P



TE Part #284052-E  
SRCA 2,54 3 M 1 SMD 137 E1 094 \* GURT \*



TE Part #1241152-4  
4P HV100 REC. CON, SMD, GOLD, BLISTER

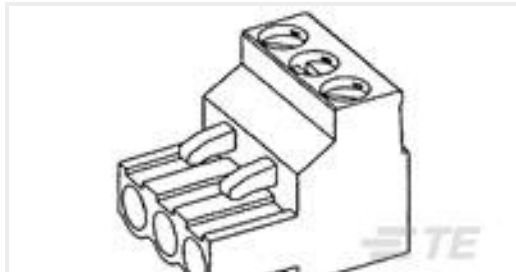

TE Part #282808-3  
TERMI-BLOK PLUG STACKING 3P.10



TE Part #1-1625999-8  
HSC100 220R 5%



TE Part #4-2176459-2  
SMW 7W 5R1 5% Taped

Documents

Product Drawings

KEB 3A 1S SPADE DELTA 520VAC

English

CAD Files

Customer View Model

ENG\_CVM\_CVM\_4-1609965-1\_B.3d\_igs.zip

English

Customer View Model

3KEBS1BFPD

3 A 3-Phase Filter, FASTON Input, .250" FASTON Output, DELTA (3 wire + ground),  
520 VAC, Chassis Mount, Corcom KEB



[ENG\\_CVM\\_CVM\\_4-1609965-1\\_B.3d\\_stp.zip](#)

English

Customer View Model

[ENG\\_CVM\\_CVM\\_4-1609965-1\\_B.2d\\_dxf.zip](#)

English

3D PDF

3D

By downloading the CAD file I accept and agree to the [Terms and Conditions](#) of use.

Datasheets & Catalog Pages

KEB SERIES

English