



Heat Shrink Tubing > Single Wall SFR: Heat Shrink Tubing, 1.75:1 Shrink Ratio



Tubing Product Type: **Heat Shrink Tubing**

Primary Product Color: **Black**

Shrink Ratio: **1.75:1**

Wall Type: **Single Wall**

Recovered Inside Diameter (Max): **10.9 mm [.429 in]**

[All Single Wall SFR: Heat Shrink Tubing, 1.75:1 Shrink Ratio \(13\)](#)

Features

Product Type Features

Tubing Product Type	Heat Shrink Tubing
Wall Type	Single Wall

Electrical Characteristics

Operating Voltage (Max)	.6 kV
-------------------------	-------

Body Features

Fluid Type	Aviation Fuel, Brake Fluid, Hydraulic Fluid, Lubricating Oil, Water
Primary Product Color	Black
Shrink Ratio	1.75:1
Primary Product Material	Crosslinked Silicone Elastomer
Flexibility	Very Flexible

Dimensions

Recovered Wall Thickness (Nominal)	1.44 mm[.057 in]
Recovered Inside Diameter (Max)	10.9 mm[.429 in]
Expanded Inside Diameter (Min)	19.1 mm[.75 in]

Usage Conditions

Shrink Temperature (Min)	175 °C
--------------------------	--------



Tubing Flammability Type	Flame-Retardant
Operating Temperature Range	-75 – 180 °C
Recovery Temperature	175 °C

Operation/Application

Mechanical Resistance	Fluids, Strain Relief
-----------------------	-----------------------

Product Availability

Applicable Region	Worldwide
-------------------	-----------

Packaging Features

Packaging Method	Piece
------------------	-------

Other

Meets Low Outgassing Requirements	No
Product Source	US

Product Compliance

For compliance documentation, visit the product page on TE.com>

EU RoHS Directive 2011/65/EU	Compliant
EU ELV Directive 2000/53/EC	Compliant
China RoHS 2 Directive MIIT Order No 32, 2016	No Restricted Materials Above Threshold
EU REACH Regulation (EC) No. 1907/2006	Current ECHA Candidate List: JAN 2025 (247) Candidate List Declared Against: JUNE 2024 (241) Does not contain REACH SVHC
Halogen Content	Low Bromine/Chlorine - Br and Cl < 900 ppm per homogenous material. Also BFR /CFR/PVC Free
Solder Process Capability	Not applicable for solder process capability

Product Compliance Disclaimer

This information is provided based on reasonable inquiry of our suppliers and represents our current actual knowledge based on the information they provided. This information is subject to change. The part numbers that TE has identified as EU RoHS compliant have a maximum concentration of 0.1% by weight in homogenous materials for lead, hexavalent chromium, mercury, PBB, PBDE, DBP, BBP, DEHP, DIBP, and 0.01% for cadmium, or qualify for an exemption to these limits as defined in the Annexes of Directive 2011/65/EU (RoHS2). Finished electrical and electronic equipment products will be CE marked as required by Directive 2011/65/EU. Components may not be CE marked. Additionally, the part numbers that TE has identified as EU ELV compliant have a maximum concentration of 0.1% by weight in homogenous materials for lead, hexavalent chromium, and mercury, and 0.01% for cadmium, or qualify for an exemption to these limits as defined in the Annexes of Directive 2000/53/EC (ELV). Regarding the REACH Regulation, the information TE provides on SVHC in articles for this part number is based on the latest European Chemicals Agency (ECHA) 'Guidance on requirements for substances in articles' posted at this URL: <https://echa.europa.eu/guidance-documents/guidance-on-reach>



Also in the Series | RAYCHEM SFR

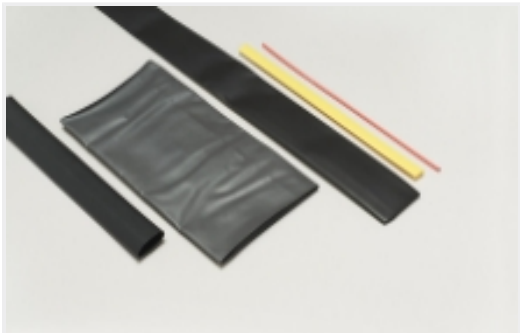

Heat Shrink Tubing(8)



Single Wall Tubing(8)

Customers Also Bought



TE Part #5660014001
SFR-1/4-0-SP



TE Part #CB4686-000
D-500-0463-H44-R120



TE Part #5039234011
DR-25-1-1/2-0-SP

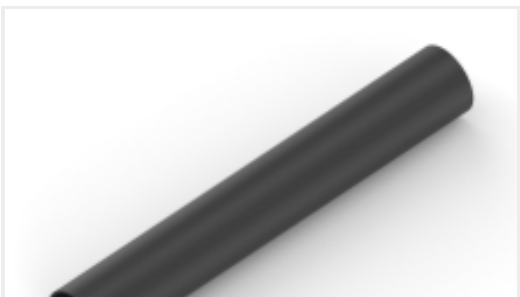

TE Part #NB17002001
DWP-125-1-0-STK

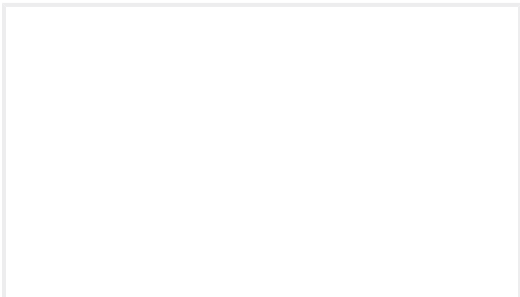

TE Part #ES2374-000
55AC1833-6-3/6/9-4



TE Part #0460-202-1631
PIN, SOLID, SIZE 16, 16-20AWG, AU



TE Part #DT04-2P-CE03
REC, 2P, BLK, E, CAP



TE Part #W6P
WEDGE LOCK, 6P, REC, GRN, DT



TE Part #ER6754-000
SFR-5/8-0-SP-CS9376

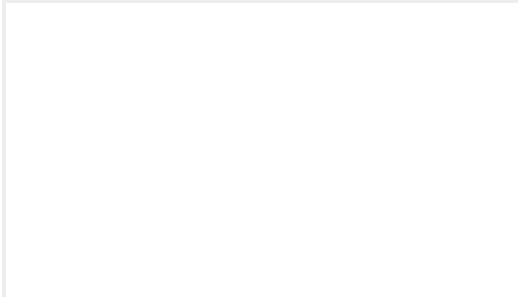

TE Part #ER6756-000
SFR-7/8-0-SP-CS9376

Documents

Product Drawings

SFR-3/4-0-SP

English

Datasheets & Catalog Pages

1654025_Sec3_SFR



English

[raychem-tubing-product-selection-guide](#)

English

Product Specifications

[Product Specification](#)

English