

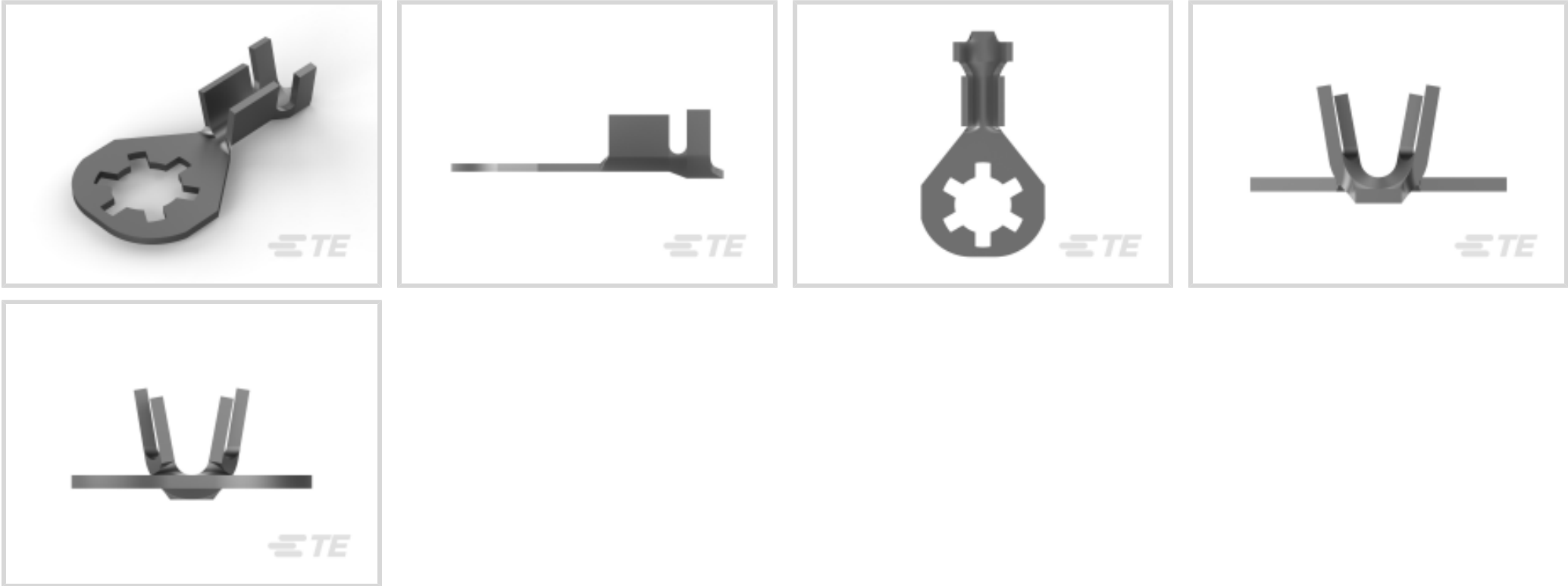

Terminals & Splices > Ring Terminals



Ring Terminal Product Type: Closed Ring Tongue Terminal

Wire Size: 1624 – 4106 CMA

Stud Size: #10

Features

Product Type Features

Shape Description	Anti-Rotational/Grounding
Ring Terminal Product Type	Closed Ring Tongue Terminal
Stud Size	#10
Sealable	No
Compatible With Discrete Wire Type	Stranded
Wire Insulation Support Retention Type	Insulation Support

Configuration Features

Number of Holes	1
-----------------	---

Body Features

Product Weight	.732 g
----------------	--------

Contact Features

Contact Base Material	Brass
Barrel Type	Open
Terminal Orientation	Straight
Terminal Plating Material	Tin
Contact Underplating Material	None



Mechanical Attachment

Wire Insulation Support	With
-------------------------	------

Dimensions

	.105 in
Wire Size	1624 – 4106 CMA
Stud Diameter	5.18 mm [.204 in]
Tongue Thickness	.76 mm [.03 in]
Product Length	19.56 mm [.77 in]
Barrel Inside Diameter	1.62 mm, 3.17 mm [.064 in] [.125 in]
Compatible Insulation Diameter (Max)	3.68 mm [.145 in]
Compatible Insulation Diameter Range	2.67 – 3.68 mm [.105 – .145 in]

Usage Conditions

Insulation Option	Uninsulated
Operating Temperature Range	-40 – 110 °C [-40 – 230 °F]

Operation/Application

Compatible With Wire Base Material	Copper
------------------------------------	--------

Industry Standards

Government Qualified Terminal	No
-------------------------------	----

Packaging Features

Packaging Quantity	9000
Packaging Method	Strip/Reel

Product Compliance

For compliance documentation, visit the product page on TE.com>

EU RoHS Directive 2011/65/EU	Compliant
EU ELV Directive 2000/53/EC	Compliant
China RoHS 2 Directive MIIT Order No 32, 2016	No Restricted Materials Above Threshold
EU REACH Regulation (EC) No. 1907/2006	Current ECHA Candidate List: JAN 2025 (247) Candidate List Declared Against: JAN 2025 (247) Does not contain REACH SVHC
Halogen Content	Low Halogen - Br, Cl, F, I < 900 ppm per homogenous material. Also BFR/CFR/PVC



Free

Solder Process Capability

Not applicable for solder process capability

Product Compliance Disclaimer

This information is provided based on reasonable inquiry of our suppliers and represents our current actual knowledge based on the information they provided. This information is subject to change. The part numbers that TE has identified as EU RoHS compliant have a maximum concentration of 0.1% by weight in homogenous materials for lead, hexavalent chromium, mercury, PBB, PBDE, DBP, BBP, DEHP, DIBP, and 0.01% for cadmium, or qualify for an exemption to these limits as defined in the Annexes of Directive 2011/65/EU (RoHS2). Finished electrical and electronic equipment products will be CE marked as required by Directive 2011/65/EU. Components may not be CE marked. Additionally, the part numbers that TE has identified as EU ELV compliant have a maximum concentration of 0.1% by weight in homogenous materials for lead, hexavalent chromium, and mercury, and 0.01% for cadmium, or qualify for an exemption to these limits as defined in the Annexes of Directive 2000/53/EC (ELV). Regarding the REACH Regulation, the information TE provides on SVHC in articles for this part number is based on the latest European Chemicals Agency (ECHA) ‘Guidance on requirements for substances in articles’ posted at this URL: <https://echa.europa.eu/guidance-documents/guidance-on-reach>

Compatible Parts



TE Part # 2150008-2
OCEAN_2.0_Applicator-E-130F180F-REA



TE Part # 1-61795-0
RING 18-14 105-145 #10 025TPBR



TE Part # 350509-1
RING 22-16 AWG BR



TE Part # 7-2150008-7
OCEAN_2.0_SPARE_PART_KIT-130F180F

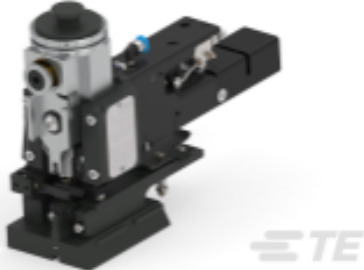

TE Part # 2150008-1
OCEAN_2.0_Applicator-E-130F180F-REM

Customers Also Bought



TE Part #2238156-1
POS LOCK 250 Rec, MKII, 22-18 TPBR



TE Part #63435-1
250 FASTON REC 14-10 AWG SPBR



TE Part #63130-2
SPLICE REC. 1500-5000 .020 BR



TE Part #520988-1
ULTRA-POD 250 ASSY REC 22-18 AWG BR



TE Part #521411-1
ULTRA-POD 250 ASY REC 22-18 AWG BR

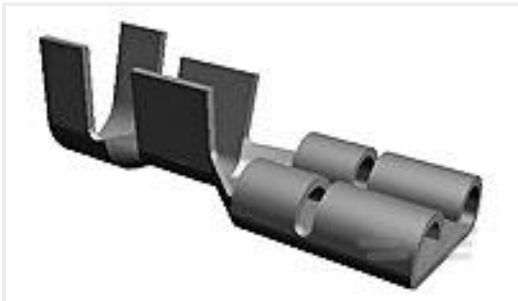

TE Part #63306-2
250 FASTON REC 18-14 AWG TPBR



TE Part #61769-1
SPLICE 1200-2600 .020 BR

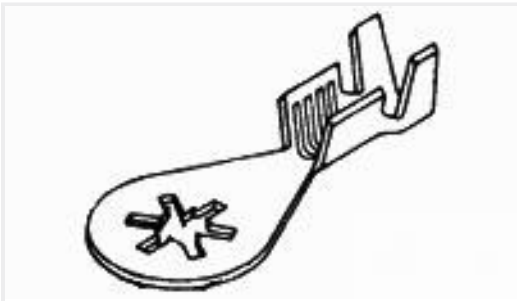

TE Part #63482-1
RING 18-14 AWG TPSTL



TE Part #521632-2
ULTRA-POD 250 ASSY REC 18-14 AWG TPBR



TE Part #CV08194001
VERSAFLEX-FR-UL-1/4-09-SP

Documents

Product Drawings
RING 18-14 AWG TPBR

English

CAD Files
3D PDF

3D

Customer View Model
ENG_CVM_CVM_61795-3_BB_c-61795-3-bb.2d_dxf.zip

English

Customer View Model
ENG_CVM_CVM_61795-3_BB_c-61795-3-bb.3d_igs.zip

English

Customer View Model
ENG_CVM_CVM_61795-3_BB_c-61795-3-bb.3d_stp.zip

English

By downloading the CAD file I accept and agree to the [Terms and Conditions](#) of use.

Product Specifications
Engineering Report

English

Agency Approvals
UL Report

English