

HD16-6-12S

✓ ACTIVE

DEUTSCH | DEUTSCH HD10, DEUTSCH HD

TE Internal #: HD16-6-12S

6 Position Housing, Housing for Female Terminals, Wire-to-Wire, Sealable, Gray, Wire & Cable, Power, Cable Mount (Free-Hanging), Hybrid

[View on TE.com >](#)



Connectors > Automotive Connectors > Automotive Housings > DEUTSCH HD10 Housings



Number of Positions: 6

Connector & Housing Type: **Housing for Female Terminals**

Mating Pin Diameter: 2.4 mm [.094 in]

Connector System: **Wire-to-Wire**

Sealable: **Yes**

[All DEUTSCH HD10 Housings \(53\)](#)

Features

Product Type Features

Mixed & Hybrid Connector	No
Connector Shape	Circular
Connector & Housing Type	Housing for Female Terminals
Connector System	Wire-to-Wire
Sealable	Yes
Primary Locking Feature	Integrated in Housing
Connector & Contact Terminates To	Wire & Cable

Configuration Features

Blank Cavity Position	0
Connector Modification	Threaded Rear
Number of Positions	6

Electrical Characteristics

Operating Voltage	250 VDC
Nominal Voltage Architecture	12 V, 24 V

Body Features

Cable Exit Angle	180°
Primary Product Color	Gray



Contact Features

Contact Size	Size 12
Contact Type	Socket
Mating Pin Diameter	2.4 mm[.094 in]
Contact Current Rating (Max)	25 A

Mechanical Attachment

Strain Relief	Without
Terminal Position Assurance	No
Mating Alignment Type	Polarizing Rib
Mating Alignment	With
Connector Mounting Type	Cable Mount (Free-Hanging)

Housing Features

Housing Material	PA GF
------------------	-------

Dimensions

Compatible Insulation Diameter Range	3.4 – 4.3 mm[.134 – .17 in]
Product Width	36.9 mm[1.45 in]
Product Length	36.9 mm[1.45 in]
Connector Height	41.1 mm[1.62 in]

Usage Conditions

Operating Temperature (Max)	125 °C[257 °F]
Operating Temperature Range	-55 – 125 °C[-67 – 257 °F]

Operation/Application

Circuit Application	Power
---------------------	-------

Industry Standards

IP Rating	IP68, IP6K9K
UL Flammability Rating	20mm Flame Test per Standard UL-94

Packaging Features

Packaging Quantity	1
Packaging Method	Package

Other

Serviceable	Yes
-------------	-----



Connector Position Assurance Capable

No

Product Compliance

For compliance documentation, visit the product page on TE.com>

EU RoHS Directive 2011/65/EU	Compliant
EU ELV Directive 2000/53/EC	Compliant
China RoHS 2 Directive MIIT Order No 32, 2016	No Restricted Materials Above Threshold
EU REACH Regulation (EC) No. 1907/2006	Current ECHA Candidate List: JAN 2025 (247) Candidate List Declared Against: JUNE 2024 (241) Does not contain REACH SVHC
Halogen Content	Not Low Halogen - contains Br or Cl > 900 ppm.
Solder Process Capability	Not reviewed for solder process capability

Product Compliance Disclaimer

This information is provided based on reasonable inquiry of our suppliers and represents our current actual knowledge based on the information they provided. This information is subject to change. The part numbers that TE has identified as EU RoHS compliant have a maximum concentration of 0.1% by weight in homogenous materials for lead, hexavalent chromium, mercury, PBB, PBDE, DBP, BBP, DEHP, DIBP, and 0.01% for cadmium, or qualify for an exemption to these limits as defined in the Annexes of Directive 2011/65/EU (RoHS2). Finished electrical and electronic equipment products will be CE marked as required by Directive 2011/65/EU. Components may not be CE marked. Additionally, the part numbers that TE has identified as EU ELV compliant have a maximum concentration of 0.1% by weight in homogenous materials for lead, hexavalent chromium, and mercury, and 0.01% for cadmium, or qualify for an exemption to these limits as defined in the Annexes of Directive 2000/53/EC (ELV). Regarding the REACH Regulation, the information TE provides on SVHC in articles for this part number is based on the latest European Chemicals Agency (ECHA) 'Guidance on requirements for substances in articles' posted at this URL: <https://echa.europa.eu/guidance-documents/guidance-on-reach>

Compatible Parts



TE Part # 0413-214-1205
SEALING PLUG, SIZE 12, KEYING, YEL



TE Part # DT-RT1
EXT TOOL, FRONT RELEASE



TE Part # HD10-6BT
BOOT, 6P, PLG/REC, ST, GRY



TE Part # 114010-ZZ
EXT TOOL, SIZE 12, 12 AWG, N, YEL



TE Part # CAT-H3910-CH8172
DEUTSCH HD10 Housings

TE Part # HD10-6BT-BK
BOOT, 6P, PLG/REC, ST, BLK

TE Part # CAT-H3910-PC1748
DEUTSCH HD10 PLUG DUST CAPS

Also in the Series | DEUTSCH HD10

Automotive Connector Caps & Covers
(26)

Automotive Headers(1)

Automotive Housings(768)

Connector Backshells(29)

PCB Headers & Receptacles(1)

Rectangular Power Connectors(1)

Wire-to-Board Headers & Receptacles
(1)

Also in the Series | DEUTSCH HD

Automotive Connector Caps & Covers
(26)

Automotive Housings(768)

Other Automotive Connector
Accessories(17)

PCB Headers & Receptacles(1)



Rectangular Power Connectors(1)

Customers Also Bought



TE Part #CAT-H3910-B128
DEUTSCH HD10 Backshells

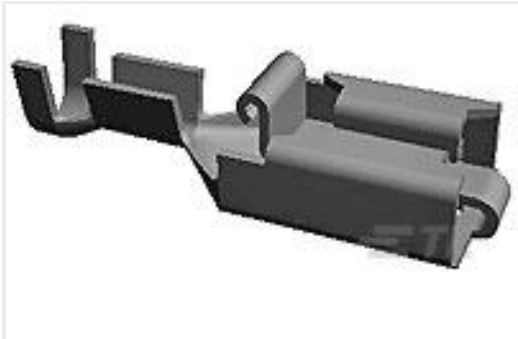

TE Part #927854-2
PL 250 REC TERMINAL 17-13 AWG
PBR



TE Part #CAT-H3910-CH8172
DEUTSCH HD10 Housings

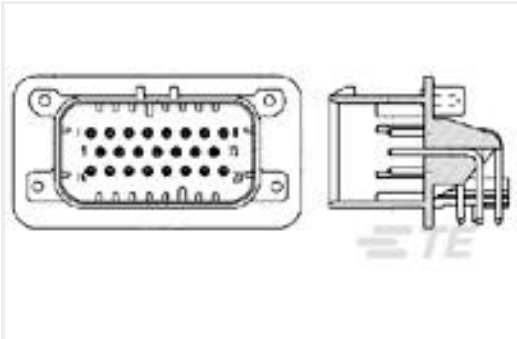

TE Part #1-776087-4
23POS,PIN DIA 1.3,HDR ASSY,90DEG,
COD 4



TE Part #CAT-H396-CH8172
DEUTSCH HDP20 Housings



TE Part #WHDS-18-2
STRAIN RELIEF, HD30, 18SZ, RA



TE Part #HDC26-24-JDL
COVER HDP 24 SHL RC RUBBER LYD

Documents

Product Drawings

PLG, 6P, GRY, N, 12

English

CAD Files

Customer View Model

ENG_CVM_CVM_HD16-6-12S_99.2d_dxf.zip

English

3D PDF

3D

Customer View Model

ENG_CVM_CVM_HD16-6-12S_99.3d_igs.zip

English

Customer View Model

ENG_CVM_CVM_HD16-6-12S_99.3d_stp.zip

English

By downloading the CAD file I accept and agree to the Terms and Conditions of use.



Datasheets & Catalog Pages

DEUTSCH HD10 CONNECTOR SERIES

English

ICT Terminals and Connectors Catalogue

English

CONNECTOR SELECTOR

English

Product Specifications

Application Specification

English

Agency Approvals

UL Report

English