



Switches > Battery Disconnect Switches > Battery Disconnect, 500A, 1 Pole



Switch Main Contact Current Rating: 500 A

Operating Voltage: 32 VDC

Number of Poles: 1

Operating Handle Type: Lever

Termination Thread Size: M10

[All Battery Disconnect, 500A, 1 Pole \(30\)](#)

Features

Product Type Features

Sealed Device	Yes
---------------	-----

Configuration Features

Number of Poles	1
Number of Auxiliary Contacts	0
Switch Keying Option	Removable Without Chain

Electrical Characteristics

Operating Voltage	32 VDC
Switch Main Contact Current Rating	500 A

Body Features

Operating Handle Color	Red
------------------------	-----

Mechanical Attachment

Operating Handle Type	Lever
Termination Thread Size	M10
Switch Mounting Option	Long Flange

Dimensions

Screw Hole Diameter	6.5 mm[.256 in]
---------------------	-----------------



Centerline Between Flange Screw Holes

100 mm[3.937 in]

Usage Conditions

Operating Temperature Range	-40 – 85 °C[-40 – 185 °F]
-----------------------------	---------------------------

Product Compliance

For compliance documentation, visit the product page on TE.com>

EU RoHS Directive 2011/65/EU	Not Compliant
EU ELV Directive 2000/53/EC	Compliant with Exemptions
China RoHS 2 Directive MIIT Order No 32, 2016	Restricted Materials Above Threshold
EU REACH Regulation (EC) No. 1907/2006	Current ECHA Candidate List: JAN 2025 (247) Candidate List Declared Against: JAN 2025 (247) SVHC > Threshold: Pb (3.5% in Component Part) Article Safe Usage Statements: Do not eat, drink or smoke when using this product. Wash thoroughly after handling. Recycle if possible and dispose of the article by following all applicable governmental regulations relevant to your geographic location.
Halogen Content	Not Yet Reviewed for halogen content
Solder Process Capability	Not reviewed for solder process capability

Product Compliance Disclaimer

This information is provided based on reasonable inquiry of our suppliers and represents our current actual knowledge based on the information they provided. This information is subject to change. The part numbers that TE has identified as EU RoHS compliant have a maximum concentration of 0.1% by weight in homogenous materials for lead, hexavalent chromium, mercury, PBB, PBDE, DBP, BBP, DEHP, DIBP, and 0.01% for cadmium, or qualify for an exemption to these limits as defined in the Annexes of Directive 2011/65/EU (RoHS2). Finished electrical and electronic equipment products will be CE marked as required by Directive 2011/65/EU. Components may not be CE marked. Additionally, the part numbers that TE has identified as EU ELV compliant have a maximum concentration of 0.1% by weight in homogenous materials for lead, hexavalent chromium, and mercury, and 0.01% for cadmium, or qualify for an exemption to these limits as defined in the Annexes of Directive 2000/53/EC (ELV). Regarding the REACH Regulation, the information TE provides on SVHC in articles for this part number is based on the latest European Chemicals Agency (ECHA) ‘Guidance on requirements for substances in articles’ posted at this URL: <https://echa.europa.eu/guidance-documents/guidance-on-reach>

Compatible Parts

 <div>TE Part # K1145220 MOUNTING BRACKET 35-500-131</div>	 <div>TE Part # CAT-AL4-SBD355002 Battery Disconnect, 500A, 2 Pole</div>	 <div>TE Part # CAT-AL4-SBD355001 Battery Disconnect, 500A, 1 Pole</div>
---	--	---



Also in the Series

KISSLING Series 35



Battery Disconnect Switches(175)



Rotary Switches(6)

Customers Also Bought



TE Part #K1160848

Relay 26-70-04-907



TE Part #CAT-AL4-SBD352001

Battery Disconnecter, 200A, 1 Pole



TE Part #K1137217

Battery Disconnecter 35-524-231-R-900



TE Part #HDP24-24-31PE-L017

REC, 31P, BLK, E, RNG, 16, P



TE Part #K1021032

Relay 29-312-12



TE Part #183025-1

MINI MIC RECPT C



TE Part #1-66359-4

III+ PIN, 18-14, TIN, STRIP



TE Part #1-1776296-2

TSB5001231DS=EUROPA T-BLK, 10MM

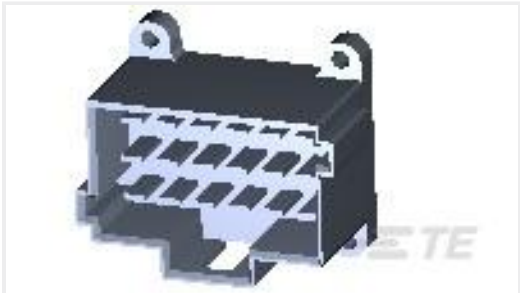

TE Part #967116-2

MESSERLEISTE 18P

Documents

Product Drawings

Battery Disconnecter 35-511-100-R

English

CAD Files

3D PDF

3D



Customer View Model

[ENG_CVM_CVM_35-511-100-R_A.2d_dxf.zip](#)

English

Customer View Model

[ENG_CVM_CVM_35-511-100-R_A.3d_igs.zip](#)

English

Customer View Model

[ENG_CVM_CVM_35-511-100-R_A.3d_stp.zip](#)

English

By downloading the CAD file I accept and agree to the [Terms and Conditions](#) of use.

Datasheets & Catalog Pages

[KISSLING BATTERY DISCONNECTOR Series 35 / 500A](#)

English